

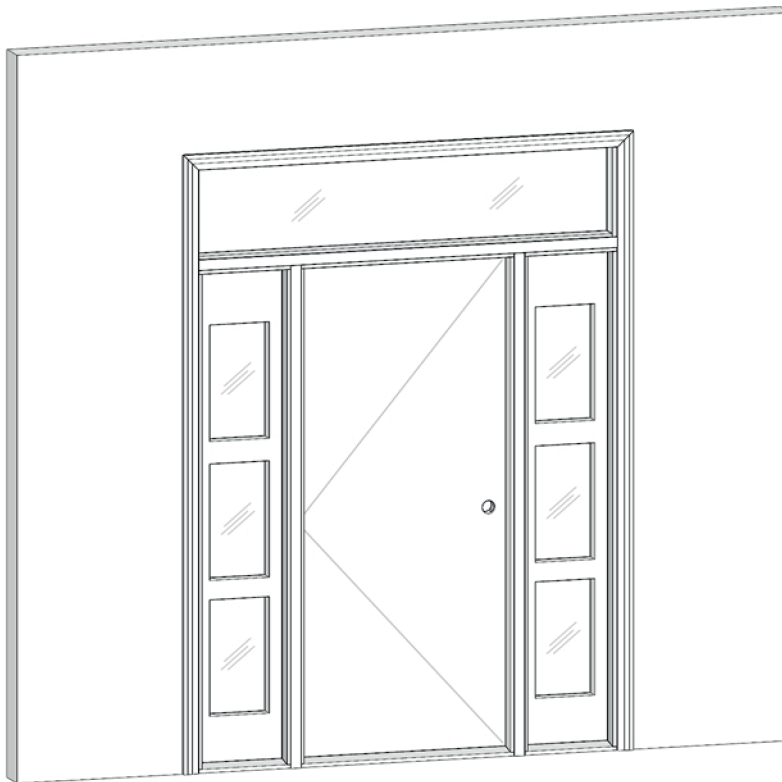

# Swing - With Sidelites and Transom

Installation Guide



[www.doornmore.com](http://www.doornmore.com)

# Required Tools

☐ Safety Glasses

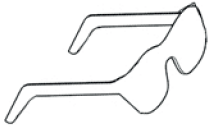

☐ Level

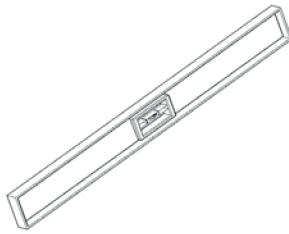

☐ Speed Square

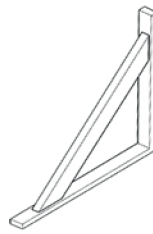

☐ Measuring Tape

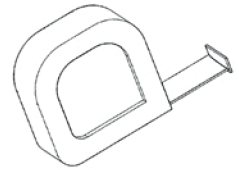

☐ Hammer

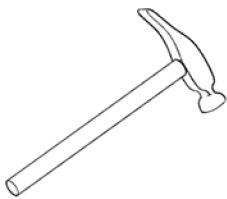

☐ Screwdriver



☐ Drill



☐ Screws

(For mounting the frame to the wall)



☐ Wooden Shims

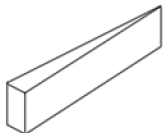

☐ Outdoor Silicone



☐ Finishing Nailer



☐ Saw

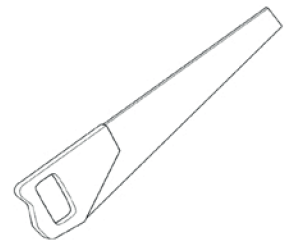

☐ Serrated Knife

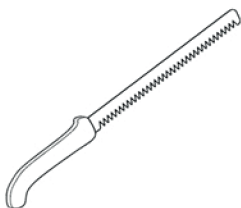

☐ Door Foam



## Disclaimer:

*This installation guide does not cover all situations, variations, details, or scenarios concerned with the installation, operation, or maintenance of your entry system, nor does it claim to. These instructions are designed to provide general assistance in the installation of your entry system. Always consult a professional to ensure proper treatment for your door and your environment. Warranty available at [www.doornmore.com](http://www.doornmore.com).*



[www.doornmore.com](http://www.doornmore.com)

# Unpacking your Entry System

□ Door

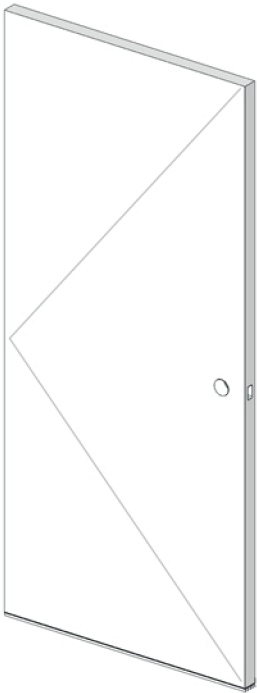

□ Brickmolding x3



□ Casing x3



□ Side jamb x2  
□ Header + 6 Screws  
□ Sill + 6 Screws



□ Sidelite x1 or x2  
- Arrives Preassembled



□ Mullion x6

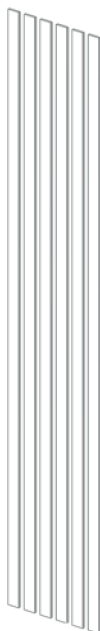

□ Transom  
- Arrives Preassembled

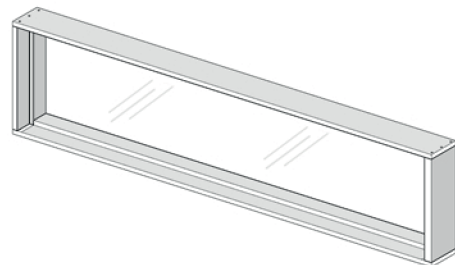

## Preparing the Rough Opening

### Step 1

- ☐ Check the dimensions of the rough opening.
  - The opening should be at least 1" wider than the net frame size plus any sidelites & 1/2" taller than the net frame size plus any transoms.
- ☐ Check that the floor beneath the sill is level.
- ☐ Check that the rough opening is plumb and square.

Your opening may look different than the figure depending on the door to be installed.

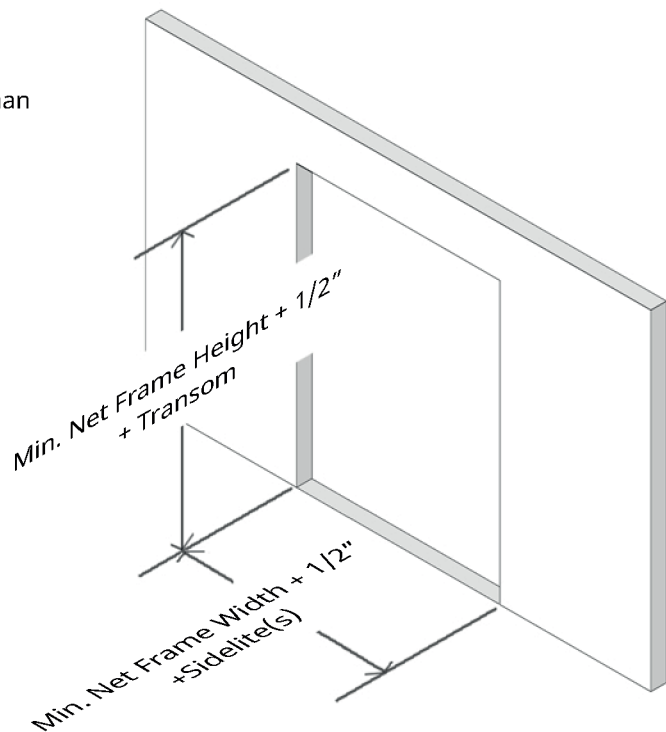

## Constructing the Frame

### Step 2

- ☐ Identify and remove the two side jambs, the header, and the sill.
- ☐ Remove the screws from the header and the sill.
- ☐ Attach the header and sill to one side jamb with the provided screws, applying silicone to the joining faces.
- ☐ Attach the other side jamb to the header and sill with the provided screws, applying silicone to the joining faces.
- ☐ Check that the frame is properly assembled, square, and plumb.

Your frame may look different than the figure depending on the door to be installed. The number of hinges and screws vary based on the dimensions of the door.

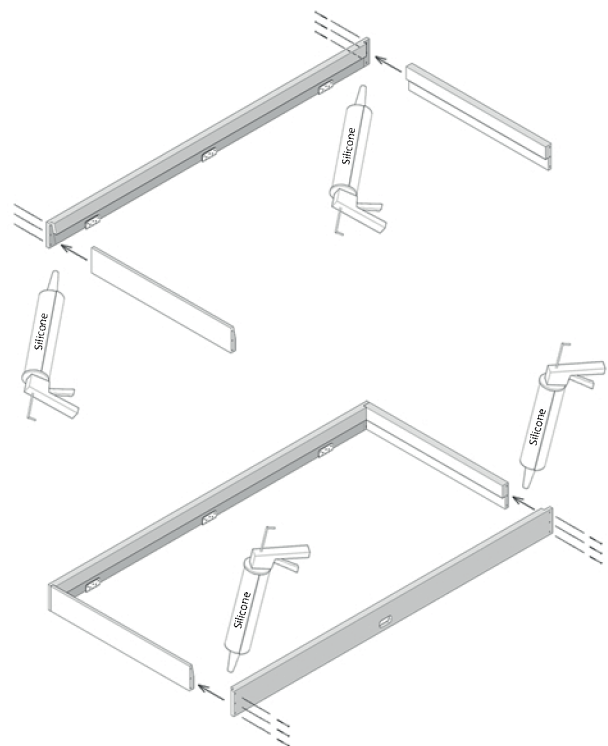

## Assembling the Frame System

### Step 3

- ☐ Attach the frame to the sidelite(s) with the appropriate screws (not provided) through the side jambs of the frame, and in the opposite direction through the side jambs of the sidelite(s).
  - Be sure to screw through shims.
- ☐ Attach the transom with the appropriate screws (not provided).

Screws affix the frame firmly into place - The amount and locations you need may vary.

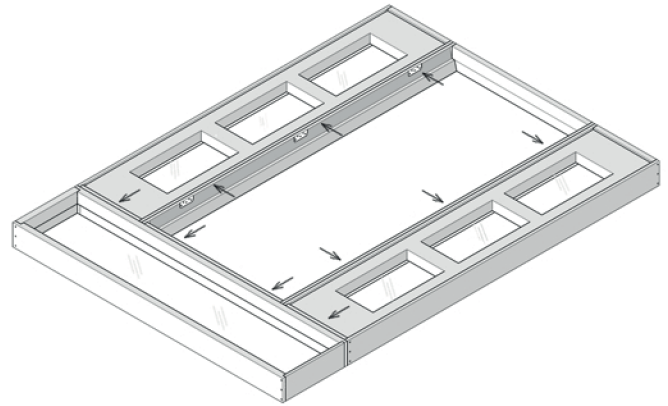

## Inserting the Assembly

### Step 4

- ☐ Apply silicone to the sub-floor beneath where the sills will sit.
- ☐ Check that the height of the interior flooring will sit beneath the sills.
- ☐ Lean the assembled frame + sidelite(s) into the rough opening, making sure the door will swing the appropriate way.
  - The door will swing towards the side that the hinges will be visible from.
- ☐ Check that the sill is level.

If the full assembly is too heavy or bulky to install in one piece, the transom can be detached and reattached after the remaining assembly is installed.

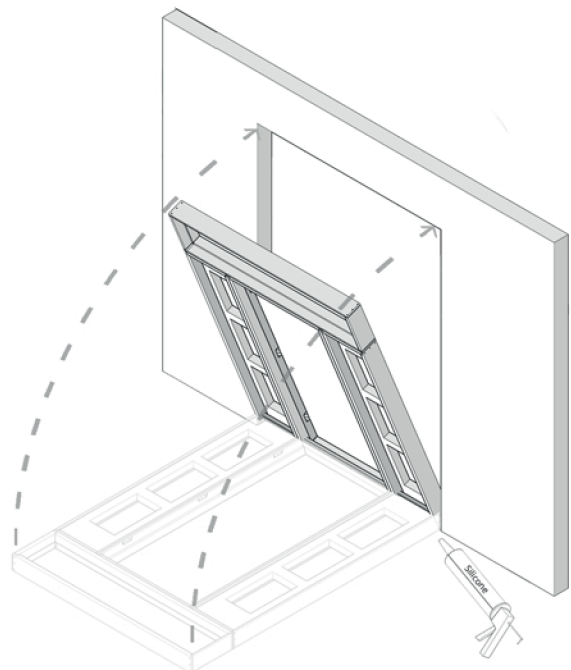

## Securing the Assembly

### Step 5

- ❑ Hammer shims between the assembly and the rough opening until the assembly is tightly installed.
  - Shims should be paired opposite one another.
- ❑ Check that the installed frame is plumb and level.

Shims are required to keep the assembly rigid and in place - The amount and locations you need may vary.

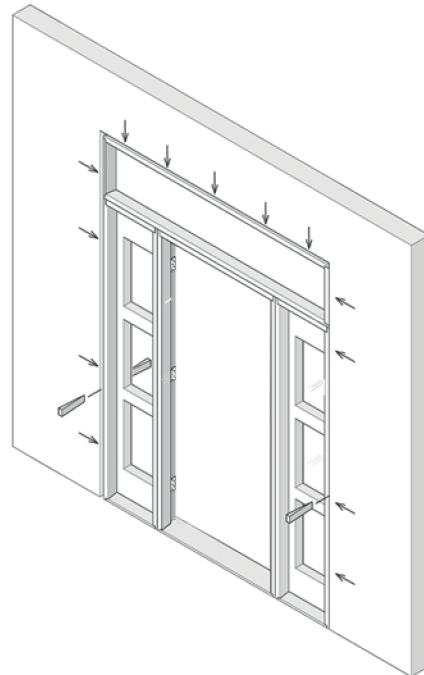

## Attaching the Assembly

### Step 6

- ❑ Attach the assembly to the rough opening with the appropriate screws (not provided) through the side jambs and the transom.
  - Be sure to screw through shims and fully into the rough opening.

Screws affix the assembly firmly into place - The amount and locations you need may vary.

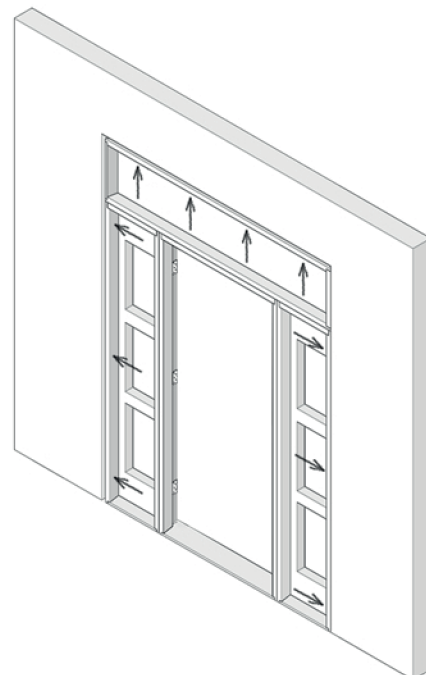

## Installing the Door

### Step 7

- ☐ Remove the screws from the hinge slot on the door.
- ☐ Placing the door within the frame, align the hinges from the frame to the hinge slots on the door.
- ☐ Attach the door to the hinges using the provided screws.

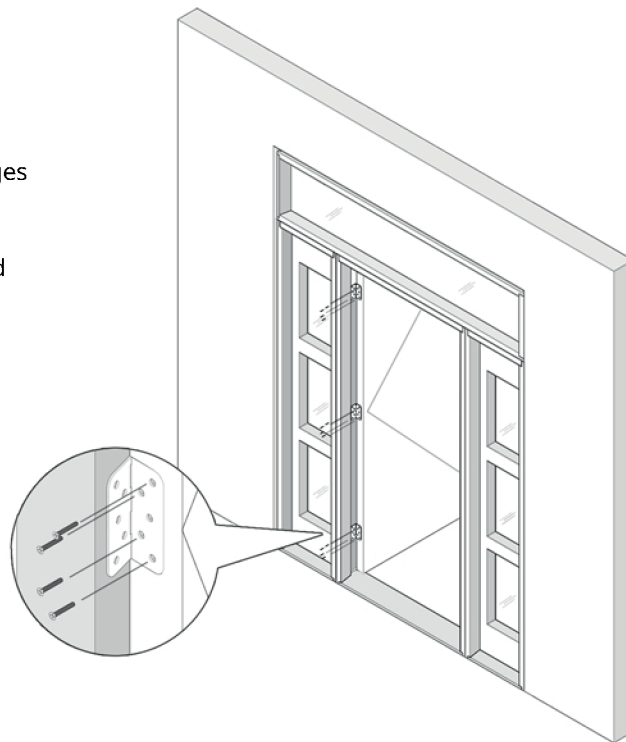

## Adjusting the Sill Height

### Step 8

- ☐ Pry off the adjustment cap from the sill and, using a screwdriver, adjust the sill height to create a proper seal.
  - There may be more than one screw to adjust on the sill.
- ☐ Replace the adjustment cap.
- ☐ Assure the door swings freely and closes tightly against the weatherstripping.

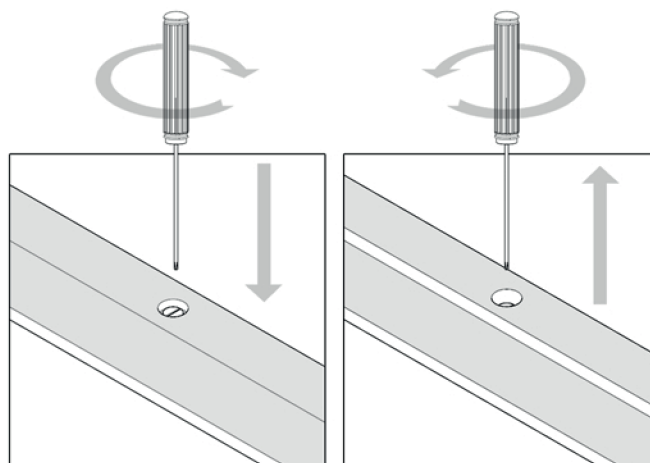
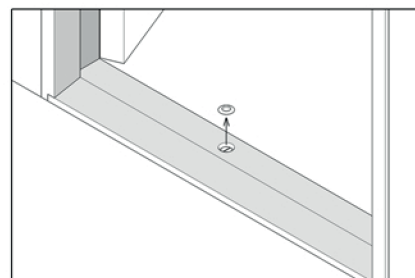

If your door system is outswing, there will not be an adjustment cap.

## Cutting the Brickmolding

## Step 9

- ❑ Identify the provided brickmolds.
  - The two longer pieces will cover the gap between the side jamb or sidelite(s) and the rough opening.
  - The shorter piece will cover the gap between the header and the rough opening.
- ❑ Using the height of the frame as reference, mark the desired height of the inner brickmold.
- ❑ With a speed square, scribe a 45° line from the previous mark out towards the extra material and cut along the drawn line.
- ❑ Repeat, mirrored, for the other long piece of brickmold.
- ❑ On the shorter brickmold, mark the corners of the width of the rough opening.
- ❑ With a speed square, scribe a 45° line from the previous marks towards the extra material and cut along the drawn line.

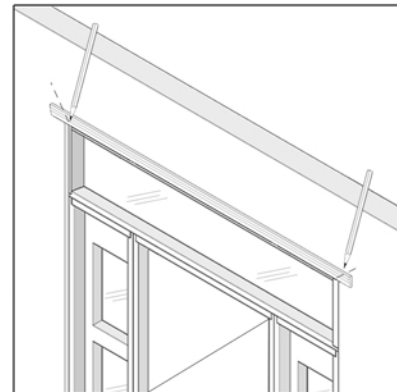
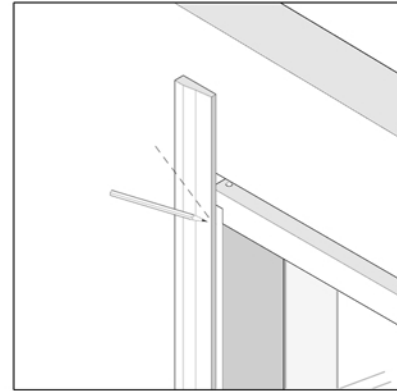

## Attaching the Brickmolding

## Step 10

- ❑ Affix both long pieces of brickmold to the external sides of the doorway with finishing nails and apply silicone to the joining faces.
  - Make sure to cover the gap between the rough opening and the frame.
- ❑ Affix the shorter brickmold to the external top of the transom with with finishing nails and apply silicone to the joining faces.
  - Make sure to cover the gap between the rough opening and the transom.

Your brickmold may look different than the figure depending on the door to be installed. Use as many finishing nails as needed to properly secure the brickmold.

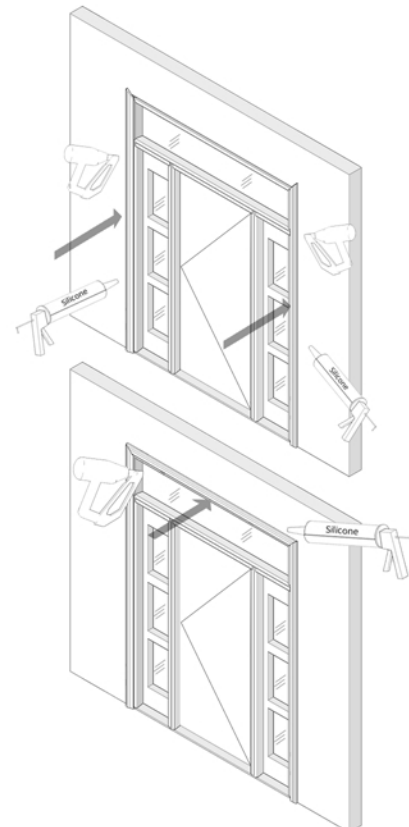



## Cutting the Casing

## Step 11

- ❑ Identify the provided casing.
  - The two longer pieces will cover the gap between the side jamb or sidelite(s) and the rough opening.
  - The shorter piece will cover the gap between the transom and the rough opening.
- ❑ Using the height of the rough opening as reference, mark the desired height of the casing across the piece and cut.
- ❑ Repeat, mirrored, for the other long piece of casing.
- ❑ On the shorter casing, mark the corners of the width of the rough opening across the piece and cut.

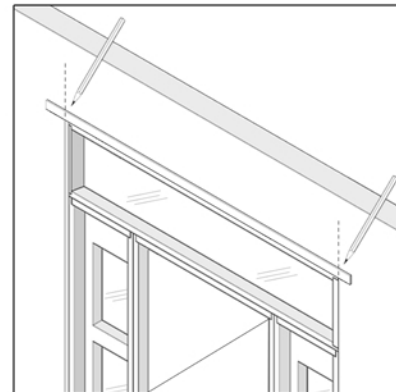
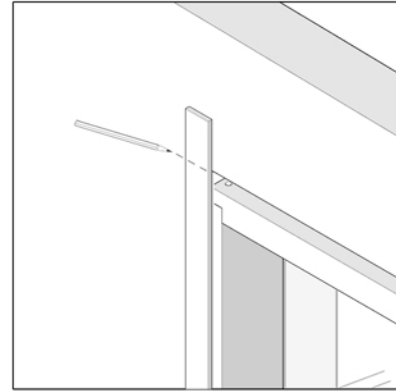

## Attaching the Casing

## Step 12

- ❑ Affix both long pieces of casing to the internal sides of the doorway with finishing nails and apply silicone to the joining faces.
  - Make sure to cover the gap between the rough opening and the frame.
- ❑ Affix the shorter casing to the internal top of the doorway with finishing nails and apply silicone to the joining faces.
  - Make sure to cover the gap between the rough opening and the frame.

Your casing may look different than the figure depending on the door to be installed. Use as many finishing nails as needed to properly secure the casing.

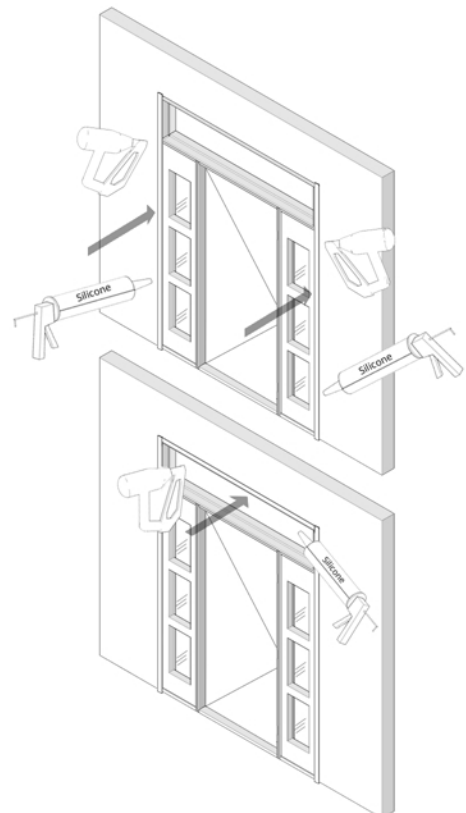

## Cutting the Horizontal Mullion(s)

## Step 13

- ❑ Identify the provided mullion(s).
- ❑ Using the width of the inner brickmolding or casing as reference, mark the desired width of the mullion across the piece and cut.
  - The mullion should span the length of the entryway and terminate into the brickmolding or casing.
- ❑ Repeat for any additional horizontal mullions.

The horizontal mullion(s) will cover the gap between the transom and the frame / sidelites.

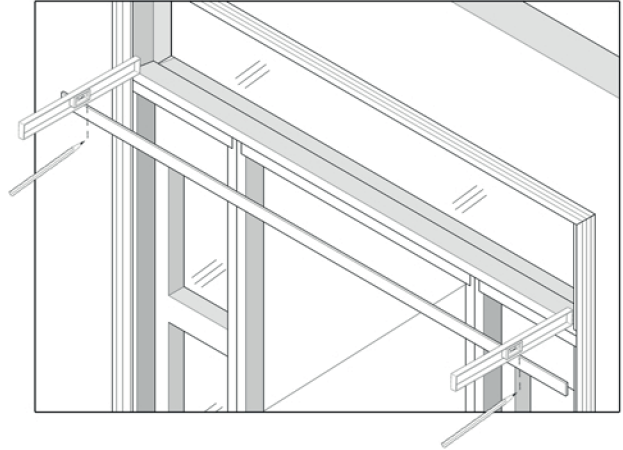

## Attaching the Horizontal Mullion(s)

## Step 14

- ❑ Affix the cut piece(s) of mullion, interior and exterior, horizontally between the transom and the frame / sidelite(s) with finishing nails and apply silicone to the joining faces.
  - Make sure to cover the seam between the transom and the frame / sidelite(s).

Your mullion(s) may look different than the figure depending on the door to be installed. Use as many finishing nails as needed to properly secure the mullion(s).

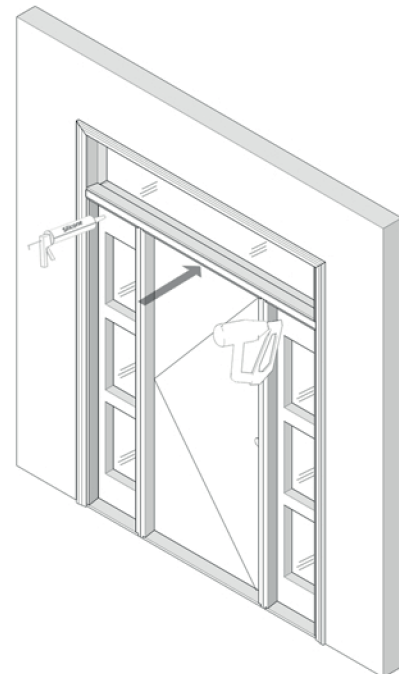

## Cutting the Vertical Mullion(s)

## Step 15

- ❑ Identify the provided mullion(s).
- ❑ Using the height of the horizontal mullion(s) as reference, mark the desired height of the vertical mullion across the piece and cut.
  - The mullion should reach the ground and terminate into the horizontal mullion.
- ❑ Repeat for any additional mullions.

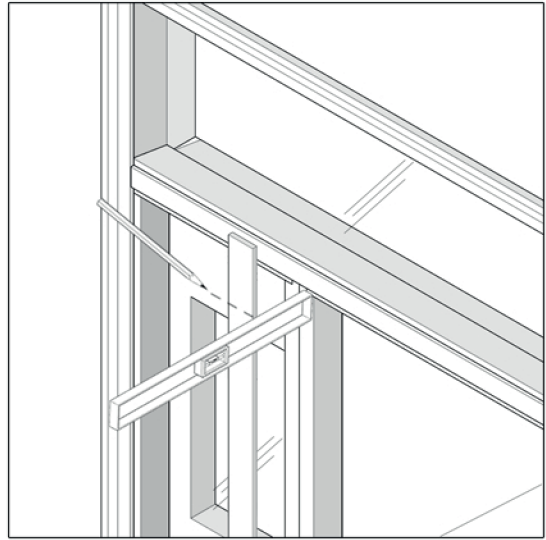

## Attaching the Vertical Mullion(s)

## Step 16

- ❑ Affix the cut piece(s) of mullion, interior and exterior, vertically between the frame and the sidelite(s) with finishing nails and apply silicone to the joining faces.
  - Make sure to cover the seam between the frame and sidelite(s).

Your mullion(s) may look different than the figure depending on the door to be installed. Use as many finishing nails as needed to properly secure the mullion(s).

