

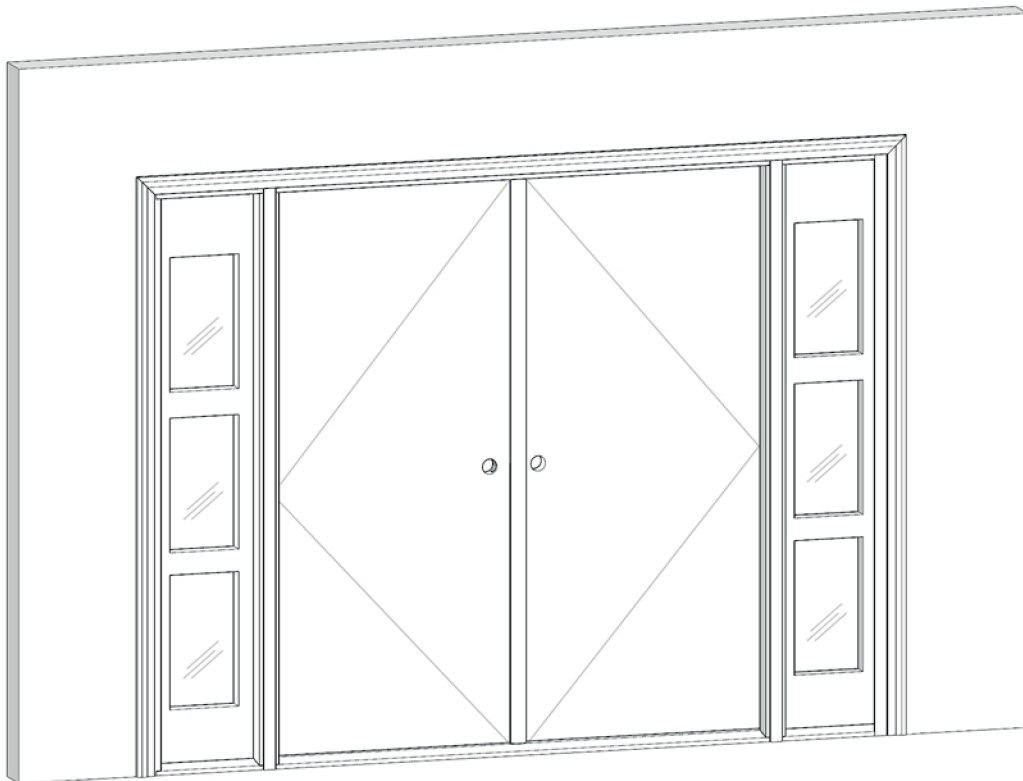

Swing - Double with Sidelites

Installation Guide



Required Tools

☐ Safety Glasses

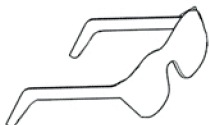

☐ Level

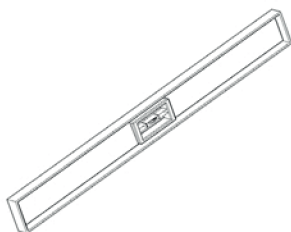

☐ Speed Square

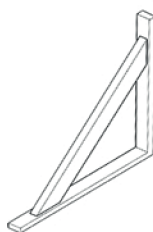

☐ Measuring Tape

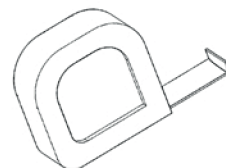

☐ Hammer

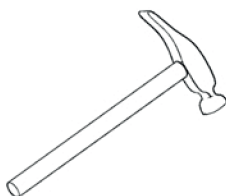

☐ Screwdriver



☐ Drill

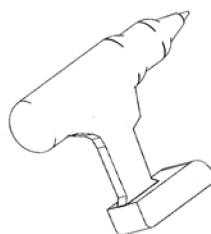

☐ Screws

(For mounting the frame to the wall)



☐ Wooden Shims

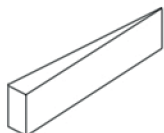

☐ Outdoor Silicone



☐ Finishing Nailer

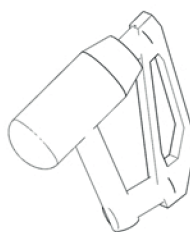

☐ Saw

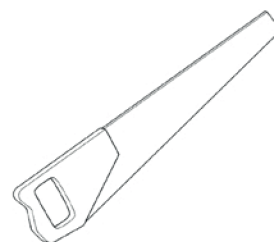

☐ Serrated Knife

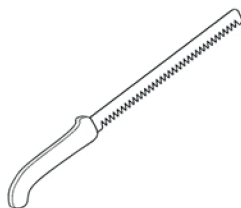

☐ Door Foam



Disclaimer:

This installation guide does not cover all situations, variations, details, or scenarios concerned with the installation, operation, or maintenance of your entry system, nor does it claim to. These instructions are designed to provide general assistance in the installation of your entry system. Always consult a professional to ensure proper treatment for your door and your environment. Warranty available at www.doornmore.com.



www.doornmore.com

Unpacking your Entry System

- Door x2
 - Passive (with astragal attached)
 - Active

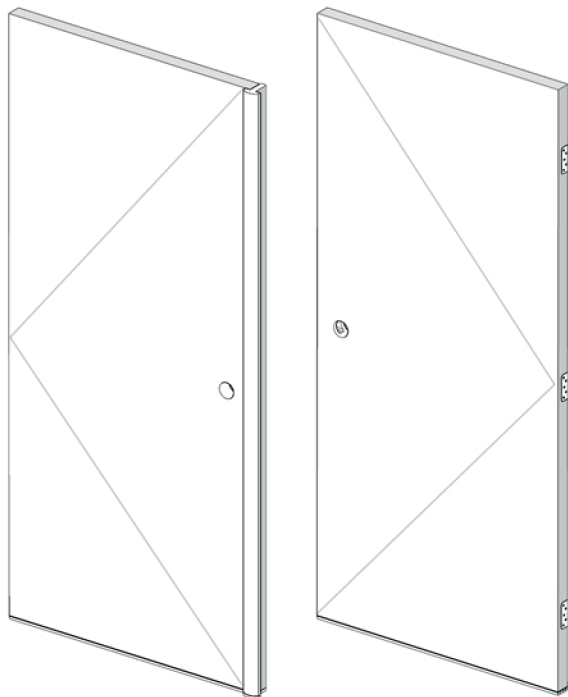

- Brickmolding x3
- Casing x3

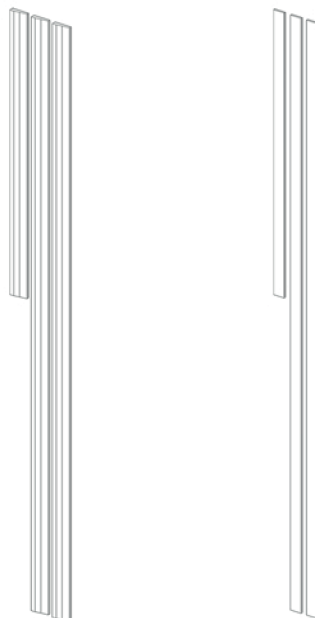

- Side jamb x2
- Header + 6 Screws
- Sill + 6 Screws



- Sidelite x1 or x2
 - Arrives Preassembled

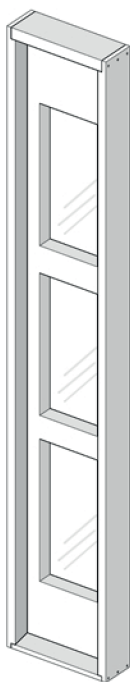

- Mullion x4



- Strike Plate + 2 Screws
(Attached to Passive Door)

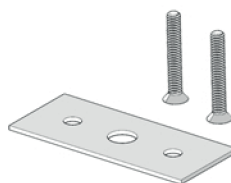

Preparing the Rough Opening

Step 1

- ☐ Check the dimensions of the rough opening.
 - The opening should be at least 1" wider than the net frame size plus any sidelites & 1/2" taller than the net frame size plus any transoms.
- ☐ Check that the floor beneath the sill is level.
- ☐ Check that the rough opening is plumb and square.

Your opening may look different than the figure depending on the door to be installed.

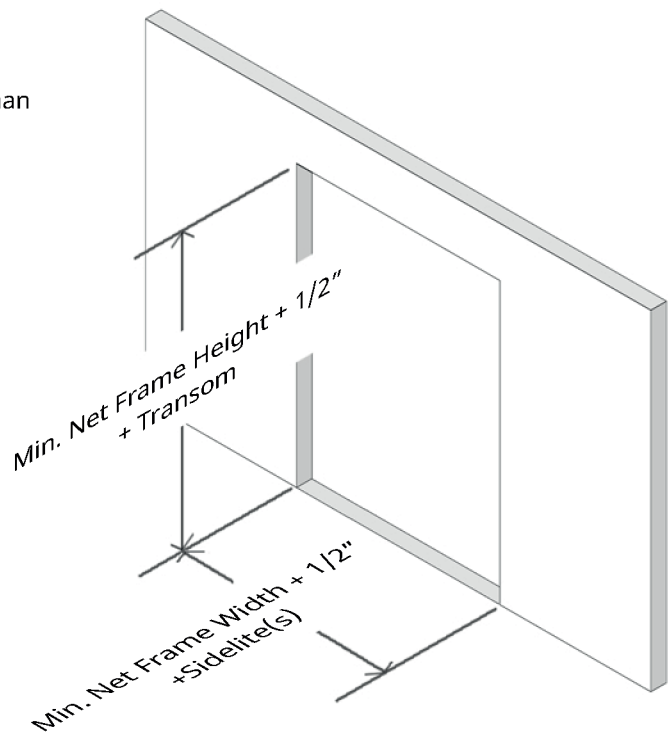

Constructing the Frame

Step 2

- ☐ Identify and remove the two side jambs, the header, and the sill.
- ☐ Remove the screws from the header and the sill.
- ☐ Attach the header and sill to one side jamb with the provided screws, applying silicone to the joining faces.
- ☐ Attach the other side jamb to the header and sill with the provided screws, applying silicone to the joining faces.
- ☐ Check that the frame is properly assembled, square, and plumb.

Your frame may look different than the figure depending on the door to be installed. The number of hinges and screws vary based on the dimensions of the door.

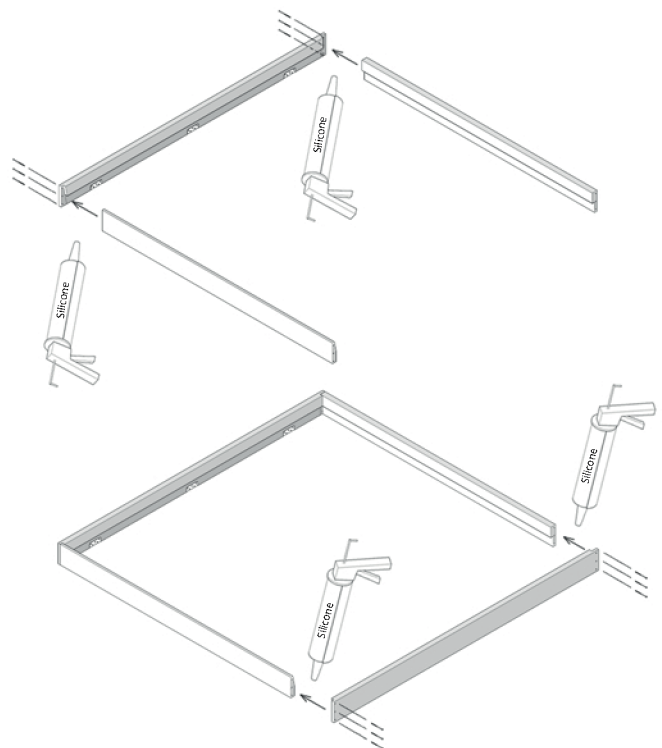

Attaching the Frame to the Sidelite(s)

Step 3

- ❑ Attach the frame to the sidelite(s) with the appropriate screws (not provided) through the side jambs of the frame, and in the opposite direction through the side jambs of the sidelite(s).
 - Be sure to screw through shims.

Screws affix the frame firmly into place - The amount and locations you need may vary.

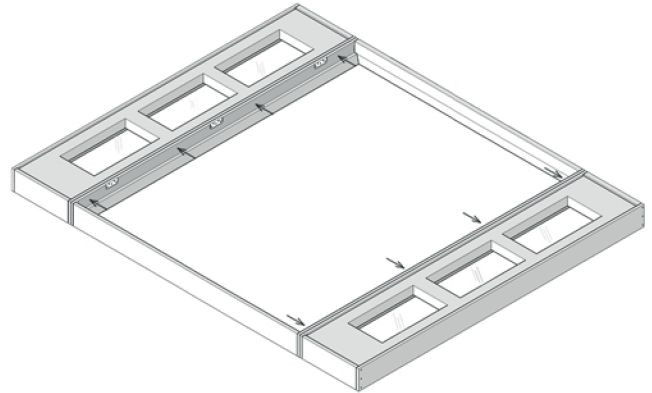

Inserting the Assembly

Step 4

- ❑ Apply silicone to the sub-floor beneath where the sills will sit.
- ❑ Check that the height of the interior flooring will sit beneath the sills.
- ❑ Lean the assembled frame + sidelite(s) into the rough opening, making sure the door will swing the appropriate way.
 - The door will swing towards the side that the hinges will be visible from.
- ❑ Check that the sill is level.

Your assembly may look different than the figure depending on the door to be installed.

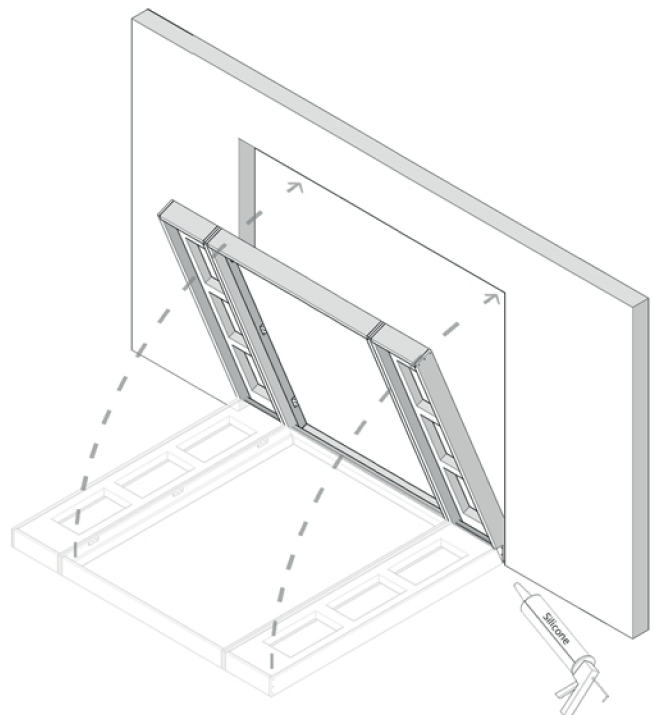

Securing the Assembly

Step 5

- ❑ Hammer shims between the frame + sidelite(s) and the rough opening until the assembly is tightly installed.
 - Shims should be paired opposite one another.
- ❑ Check that the installed assembly is plumb and level.

Shims are required to keep the assembly rigid and in place - The amount and locations you need may vary.

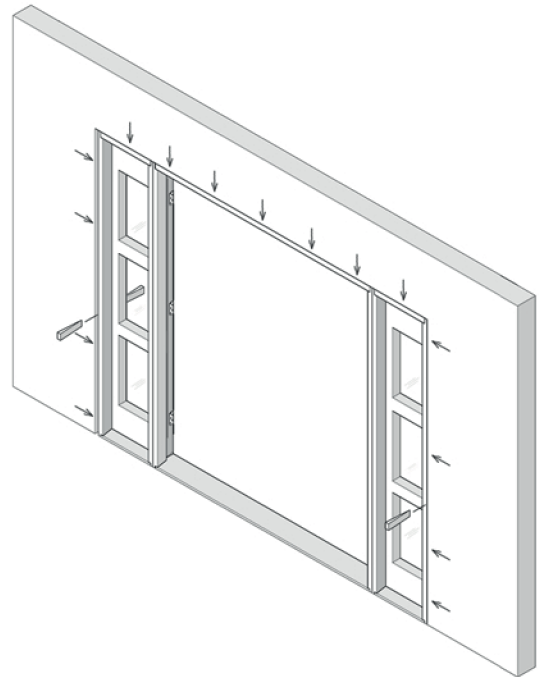

Attaching the Assembly

Step 6

- ❑ Attach the assembly to the rough opening with the appropriate screws (not provided) through the side jambs and the header.
 - Be sure to screw through shims and fully into the rough opening.

Screws affix the assembly firmly into place - The amount and locations you need may vary.

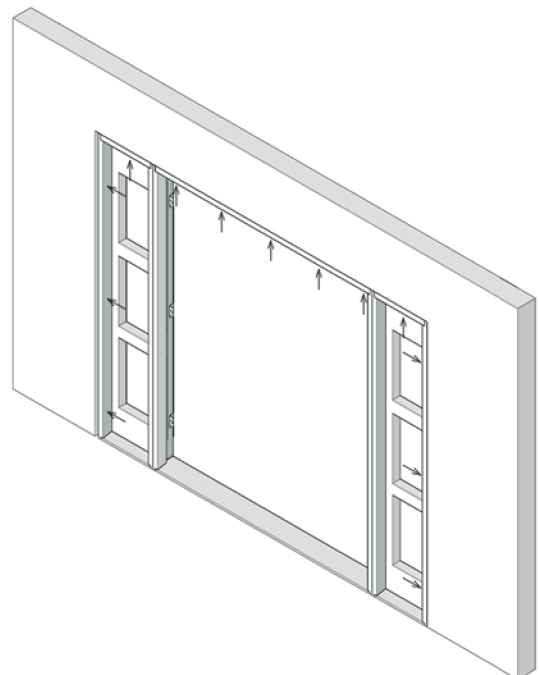

Installing the Inactive Door

Step 7

- ☐ Remove the screws from the hinge slot on the inactive door.
 - The inactive door will be the one with flush bolts installed.
- ☐ Placing the door within the frame, align the hinges from the frame to the hinge slots on the door.
- ☐ Attach the door to the hinges using the provided screws.

Your frame may look different than the figure depending on the door to be installed.

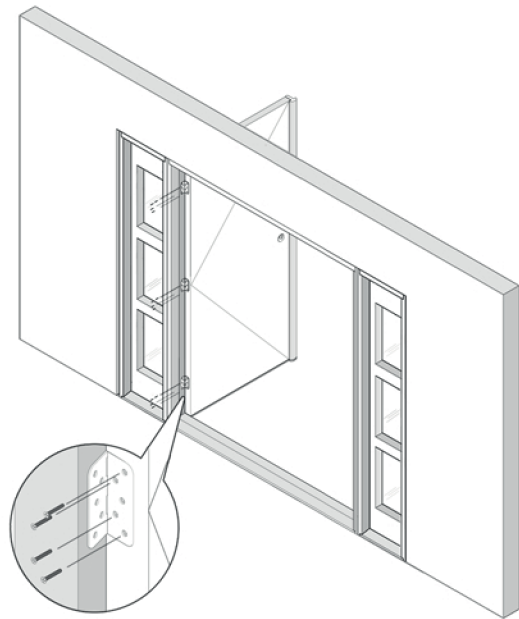

Installing the Flush Bolt

Step 8

- ☐ Unscrew the strike plate and screws from the flush bolt and replace the screw.
- ☐ With the inactive door closed, activate any flush bolts and mark where the bolt contacts the header or sill.
- ☐ Drill a hole at the mark(s) deep enough to allow the flush bolt to fully activate.
- ☐ By using the strike plate as a template, mark and drill two additional holes on the header.
 - A notch can be cut to allow the strike plate to be flush with the header.
- ☐ Attach the strike plate to the header with the provided screws.

It is advised to protect the sill by inserting a bolt cap into the drilled hole. (not provided)

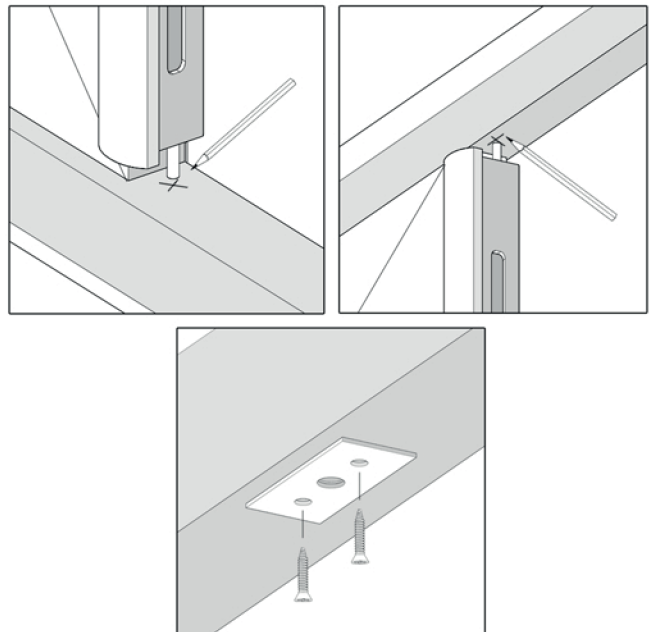

Installing the Active Door

Step 9

- ❑ Remove the screws from the hinge slot on the active door.
 - The active door will be the door without flush bolts installed.
- ❑ Placing the door within the frame, align the hinges from the frame to the hinge slots on the door.
- ❑ Attach the door to the hinges using the provided screws.

Your frame may look different than the figure depending on the door to be installed.

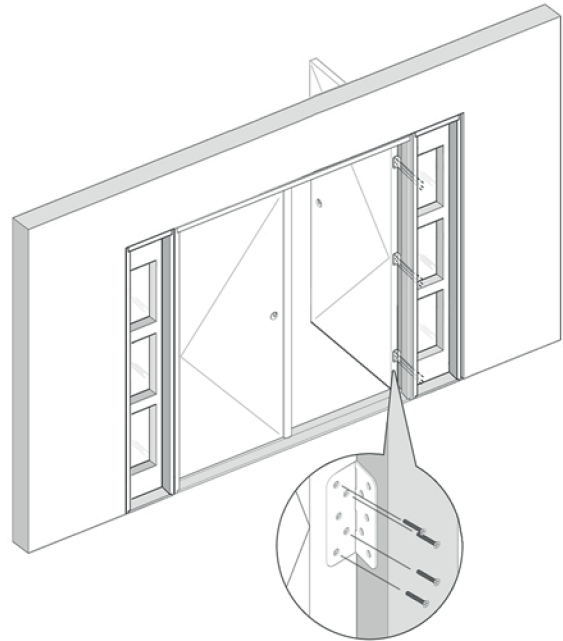

Adjusting the Sill Height

Step 10

- ❑ Pry off the adjustment cap from the sill and, using a screwdriver, adjust the sill height to create a proper seal.
 - There may be more than one screw to adjust on the sill.
- ❑ Replace the adjustment cap.
- ❑ Assure the door swings freely and closes tightly against the weatherstripping.

If your door system is outswing, there will not be an adjustment cap.

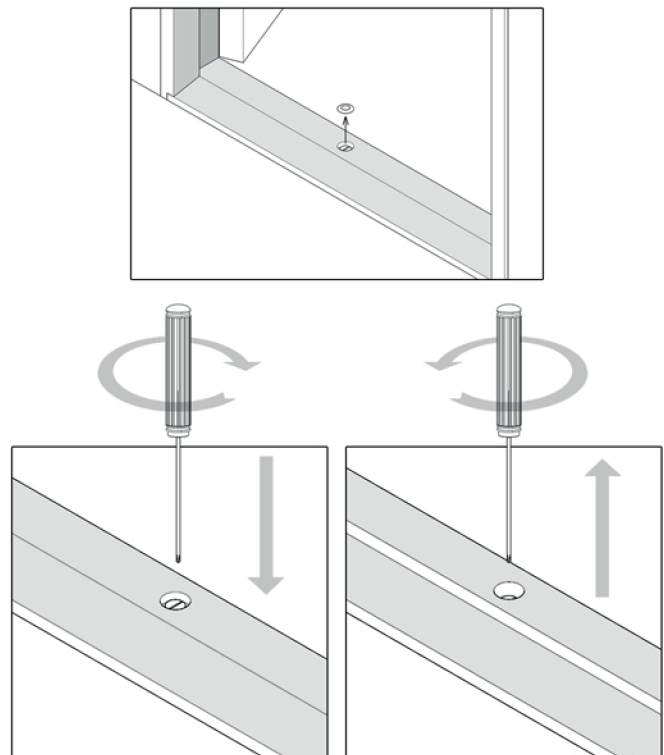

Cutting the Brickmolding

Step 11

- ☐ Identify the provided brickmolds.
 - The two longer pieces will cover the gap between the side jamb or sidelite(s) and the rough opening.
 - The shorter piece will cover the gap between the header and the rough opening.
- ☐ Using the height of the frame as reference, mark the desired height of the inner brickmold.
- ☐ With a speed square, scribe a 45° line from the previous mark out towards the extra material and cut along the drawn line.
- ☐ Repeat, mirrored, for the other long piece of brickmold.
- ☐ On the shorter brickmold, mark the corners of the width of the rough opening.
- ☐ With a speed square, scribe a 45° line from the previous marks towards the extra material and cut along the drawn line.

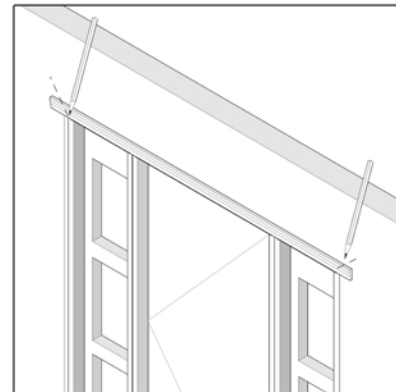
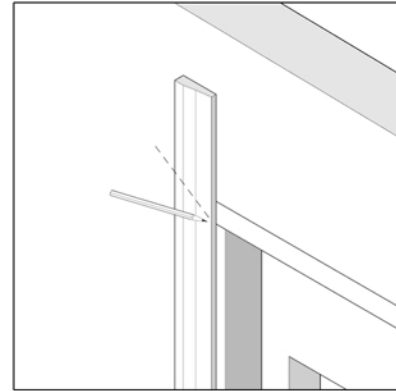

Attaching the Brickmolding

Step 12

- ☐ Affix both long pieces of brickmold to the external sides of the doorway with finishing nails and apply silicone to the joining faces.
 - Make sure to cover the gap between the rough opening and the frame.
- ☐ Affix the shorter brickmold to the external top of the doorway with finishing nails and apply silicone to the joining faces.
 - Make sure to cover the gap between the rough opening and the frame.

Your brickmold may look different than the figure depending on the door to be installed. Use as many finishing nails as needed to properly secure the brickmold.

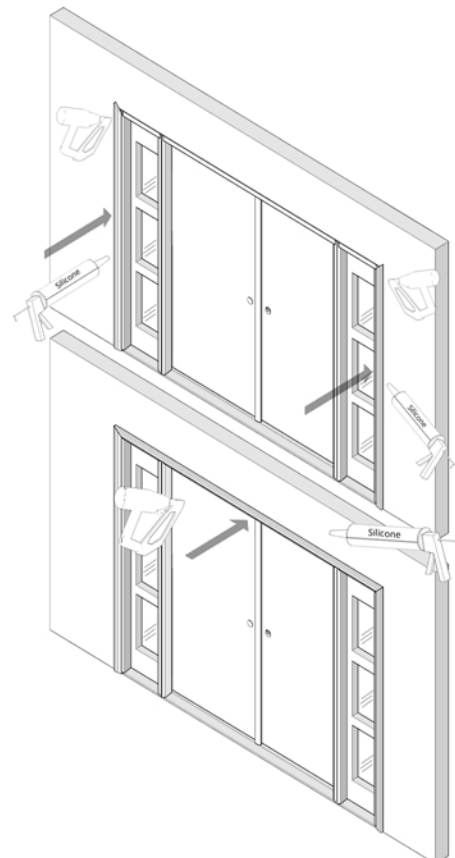

Cutting the Casing

Step 13

- ❑ Identify the provided casing.
 - The two longer pieces will cover the gap between the side jamb or sidelite(s) and the rough opening.
 - The shorter piece will cover the gap between the header and the rough opening.
- ❑ Using the height of the frame as reference, mark the desired height of the casing across the piece and cut.
- ❑ Repeat, mirrored, for the other long piece of casing.
- ❑ On the shorter casing, mark the corners of the width of the rough opening across the piece and cut.

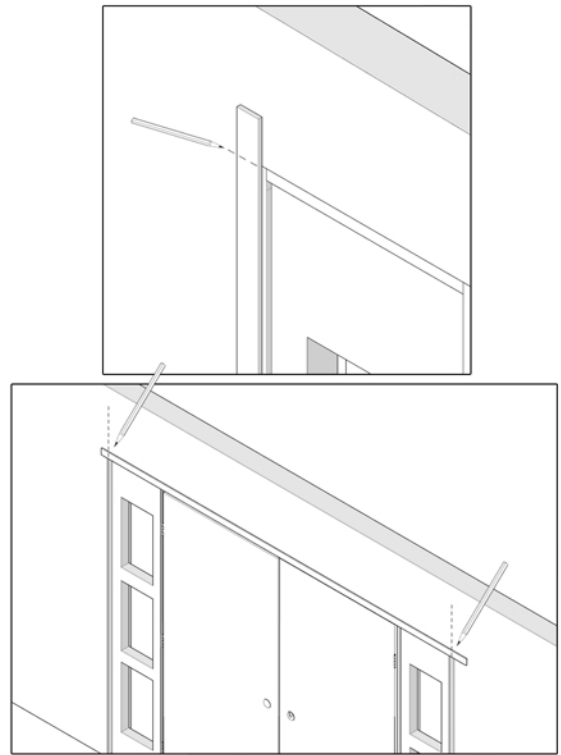

Attaching the Casing

Step 14

- ❑ Affix both long pieces of casing to the internal sides of the doorway with finishing nails and apply silicone to the joining faces.
 - Make sure to cover the gap between the rough opening and the frame.
- ❑ Affix the shorter casing to the internal top of the doorway with finishing nails and apply silicone to the joining faces.
 - Make sure to cover the gap between the rough opening and the frame.

Your casing may look different than the figure depending on the door to be installed. Use as many finishing nails as needed to properly secure the casing.

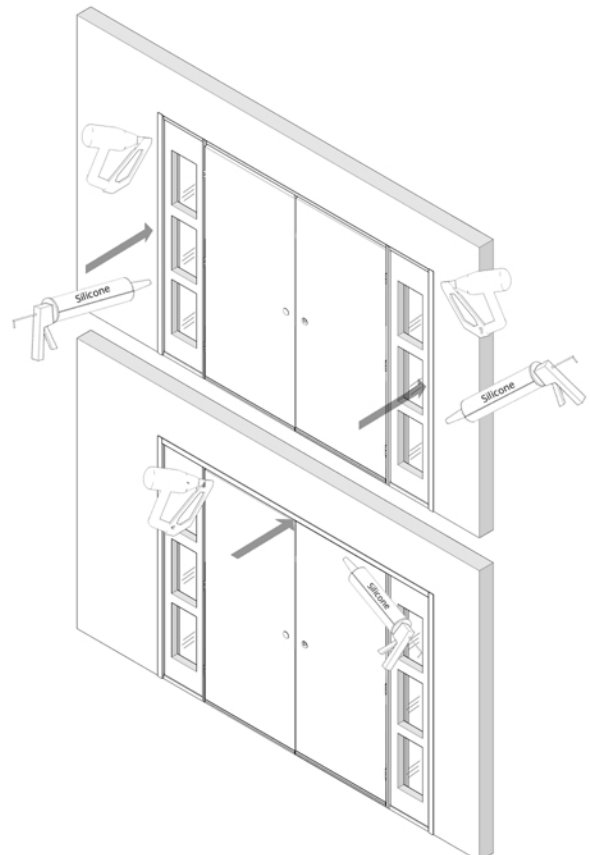

Cutting the Vertical Mullion(s)

Step 15

- ☐ Identify the provided mullion(s).
- ☐ Using the height of the brickmolding or casing as reference, mark the desired height of the mullion across the piece and cut.
 - The mullion should reach the ground and terminate into the brickmolding, casing, or horizontal mullion.
- ☐ Repeat for any additional mullions.

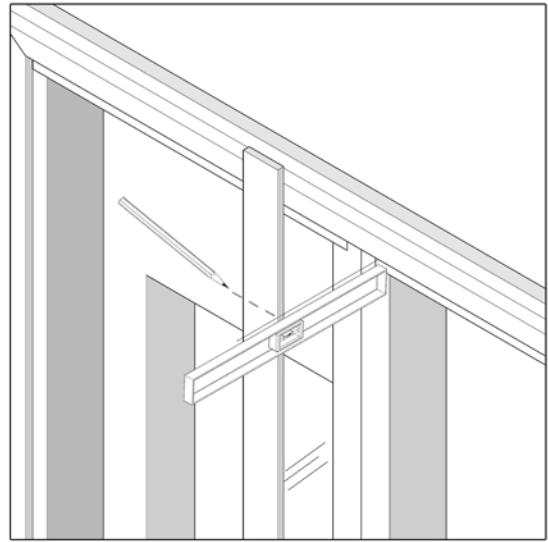

Attaching the Mullion(s)

Step 16

- ☐ Affix the cut piece(s) of mullion, interior and exterior, between the sidelites or transom and the frame with finishing nails and apply silicone to the joining faces.
 - Make sure to cover the seam between the sidelites/transom and the frame.

Your mullion(s) may look different than the figure depending on the door to be installed. Use as many finishing nails as needed to properly secure the mullion(s).

