

Basic Information and Terms for Rolling Doors

A typical BarnCraft® door installation consists of two parts; the door, and the hardware kit. These two items are to be ordered independently. Here is information on these BarnCraft® products:

IMPORTANT: All BarnCraft® rolling door installations must be installed correctly, with the hardware securely mounted onto the wall. Failure to do so could result in damage, injury, or death. Installation should be done by an experienced installer. The rollers must be installed with the distance from the bottom of the roller wheels to the top of the door at 1-7/8". And the Anti-Jump disks and floor guide must be installed in order to ensure a safe installation.

Video guides for BarnCraft® Rolling Doors:

- Several video guides are available to assist with BarnCraft Door products, including:
 - Assembly video for unassembled barn door series doors
 - Installation of a single rolling door
 - Installation of a double rolling door
 - Installation of a bypass quadruple door

Doors for Rolling Door Installations:

- Any door may be used with a rolling door installation provided that it is of an appropriate size to cover the opening
- Five styles of doors are shown in the BarnCraft Catalog: 1) Barn Doors, 2) Iron Plank Doors, 3) MDF Doors, 4) Contemporary Doors, 5) Mahogany & Glass Doors
- Any of GlassCraft's doors may be used with our Rolling Door hardware, provided that the door slab weight does not exceed 220 pounds.
- Refer to the next page for guidelines on selecting an appropriate door slab size for the opening
- When ordering for a double door installation, you must order 2 doors and 2 hardware kits

Hardware Kits for Rolling Door Installations:

- Hardware Kits consist of all necessary hardware to install a single rolling door
- All Rolling Door Hardware Kits include a steel rail. You may choose from 2 rail lengths as is appropriate for your installation.
 - **78-3/4"** length (use for door widths up to 36" wide)
 - **100"** length (use for 38" - 48" wide doors)
 - for wider custom doors, you may need to supply your own door rail, as we cannot ship parts longer than 100 inches
- Door roller straps are all made from 5mm (1/4" nominal) thick steel
- Door rollers are all made with "quiet glide" nylon

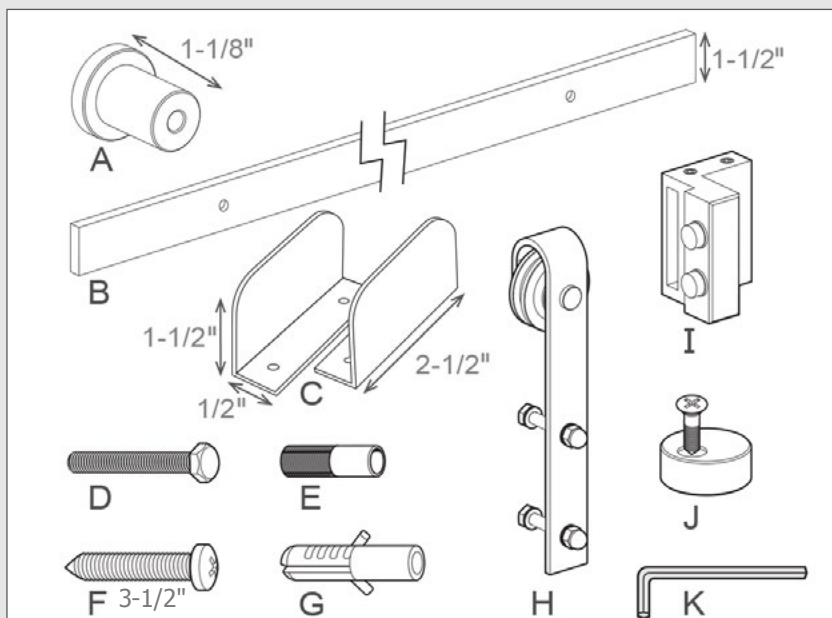

Included in the Kit

- A Stand-off Bracket (x5)
- B Rail (x1)
- C Floor Door Guide (x1)
- D Bolt (x5)
- E Bolt Wall Anchor (x5)
- F Log Bolt (x5)
- G Log Bolt Wall Anchor (x5)
- H Roller (x2)
- I Stopper (x2)
- J Anti Jump (x2)
- K Allen Wrench (x1)

Optional: Handle and Lock

Note: Hardware may be ordered with or without the BarnCraft doors.

Determining the Required Door Panel Size for Rolling Doors

The door panel needs to be slightly wider than the door opening. The door will be mounted about 1/2" to 1" above the floor level, so the door panel can be the same height as the door height opening. Here are some guidelines on measuring.

Determine the minimum door width:

To determine the minimum door width, measure the distance between the inside frame opening and add 2" to each side ($A + 2" + 2" =$ **minimum door width**). This will allow the door to cover the frame opening when the door is fully closed.

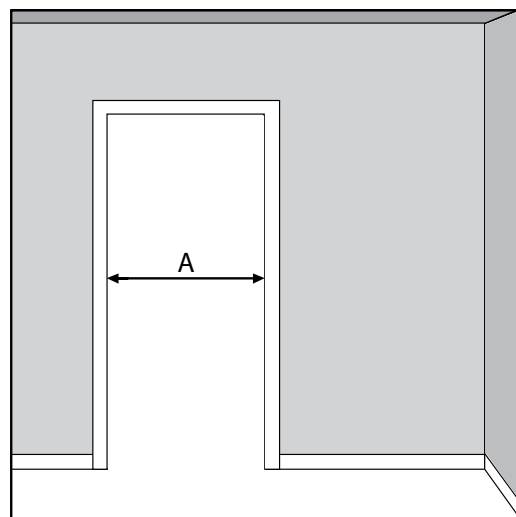

Determine the minimum door height:

To determine the minimum door height, measure between the finished floor and the frame, then subtract 1/2" for floor clearance from the bottom of the door ($B - 1/2" =$ **minimum door height**). Door may cover the top trim if desired.

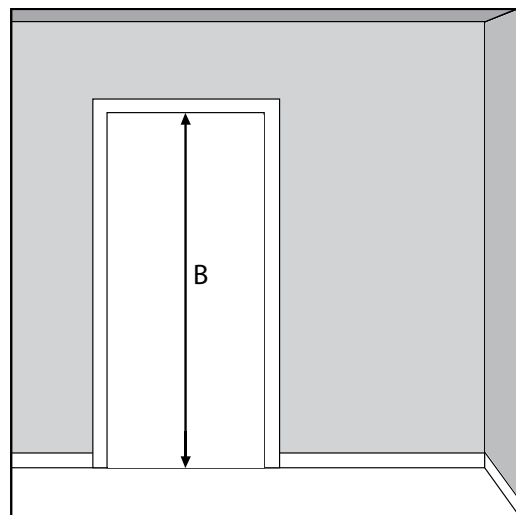

Check for minimum door clearance:

A minimum clearance of 6 1/2" (C) is required from the top of the door to the ceiling, to accommodate the track and rolling hardware. The top of the door should be level or above the frame opening.

A minimum clearance of available wall space **equal to the actual door width** is required (D) for the door to completely roll free of the door opening.

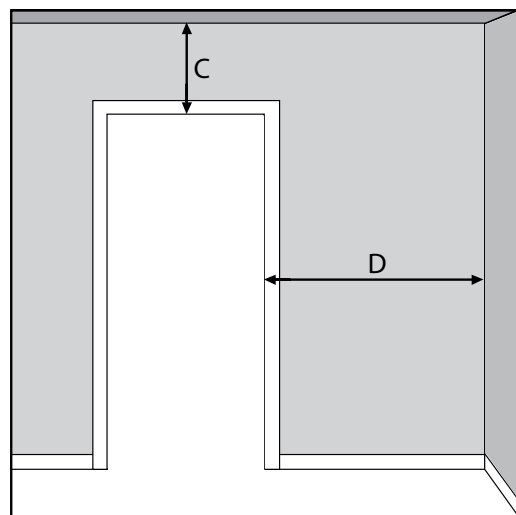

Door Factory-Finish Information

Wood Door Prefinishing Services

You may order any of the BarnCraft Series doors factory prefinished. Prices are listed in our BarnCraft price list. Ordering your door prefinished may add to the delivery time required. Please refer to the BarnCraft Catalog on pages 22-23, 46 and 56 for photos of these finish options on the various wood types. All doors may be ordered unfinished, for finishing or painting by the end user.

Urethane Finishing Process—Our environmentally-friendly finishing system utilizes stain-and-seal urethanes. This procedure uses halogen lamp convection ovens, laser temperature controllers and robotic carts on a continuous finishing line. The finished product is applied using a controlled process to ensure a long lasting and consistent product.

Our Traditional Finish produces a door with a Long-lasting beauty using a layer of urethane finish and the highest quality of penetrating stains with clear top coat and Uv inhibitors. The final top-coat provides a medium gloss finish.

Our Distressed Finish procedure produces a door with an antique and distressed appearance. This finish process is hand-applied, and each door will differ in appearance from the next. Similar to our Traditional Finish in stain and urethane top coats, this Distressed finish is available in any of our finish colors. The final top-coat provides a medium satin finish.

Our Antique Finish procedure produces a door with an antique appearance. This finish option is similar to the "Distressed finish" listed above, but does not include any of the distress marks in the wood surface. This finish process is hand-applied, and each door will differ in appearance from the next. Similar to our Traditional Finish in stain and urethane top coats, this antique finish is available in any of our finish colors. The final top-coat provides a medium satin finish.

Our Barn Wood Finish procedure produces a door with a finish similar to authentic antique barn wood. This finish process is hand-applied, and each door will differ in appearance from the next. Two barn wood finish colors are available. This finish is only available on our Barn Door Series doors, and when you order a door in Barnwood Knotty Alder.

Our Paint Finish procedure provides several regular, antique, and distressed paint finishes.



Sample of a Rustic Knotty Alder Distressed finish



Sample of a Barnwood Knotty Alder finish



Sample of an Antique Birch finish



Sample of a distressed Mahogany paint

Product Specifications: BarnCraft® Birch Contemporary Doors

Doors built for the BarnCraft Contemporary Door Series are included in our BarnCraft® Premium Rolling Barn Doors color product catalog, and have the following specifications*:

- 1) Doors are constructed using 1.75" multi-ply wood panel with a Birch veneer face on both sides. Edges of the door are capped with clear hardwood.
- 2) Choose from six glass texture options, OR from four metal grid options for the Santa Monica or Beverly door designs. Glass can not be included in conjunction with a metal grid. See glass texture and metal grid option photos below.
- 3) Glass panels in these Contemporary Doors are "single glazed" or one piece of glass. All glass is tempered for safety.
- 4) Each glass panel is a separate and individual piece of glass. Should one of these panes be broken, the individual piece is replaceable.

Available Stock Product Sizes

Birch Contemporary Doors

2' 6" x 6' 8" x 1 ³ / ₄ "	2' 6" x 7' 0" x 1 ³ / ₄ "	2' 6" x 8' 0" x 1 ³ / ₄ "
3' 0" x 6' 8" x 1 ³ / ₄ "	3' 0" x 7' 0" x 1 ³ / ₄ "	3' 0" x 8' 0" x 1 ³ / ₄ "
3' 6" x 6' 8" x 1 ³ / ₄ "	3' 6" x 7' 0" x 1 ³ / ₄ "	3' 6" x 8' 0" x 1 ³ / ₄ "
4' 0" x 6' 8" x 1 ³ / ₄ "	4' 0" x 7' 0" x 1 ³ / ₄ "	4' 0" x 8' 0" x 1 ³ / ₄ "

Door Construction

Doors: Plywood core with Birch veneer faces. Clear hardwood edge on vertical door edges. Glass is stopped in with hardwood glass stops.

Wood Type

Veneer faces of the door use American Birch.

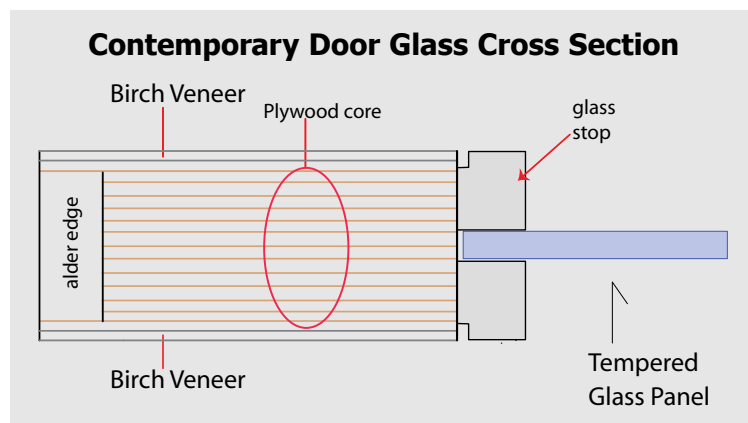

Glass Texture Options



CLEAR
1 - PRIVACY RATING

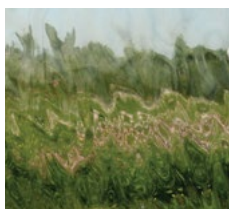

WATER
2 - PRIVACY RATING

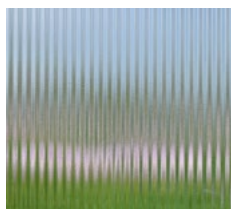

REEDS
7 - PRIVACY RATING



RAIN
9 - PRIVACY RATING



CLOUD
6 - PRIVACY RATING



MIRROR
10 - PRIVACY RATING
OPTIONS: 1 side or 2 sides;
if ordering 1 sided, back
will be Birch.

Metal Grid Options



MATRIX
4 - PRIVACY RATING



URBAN
4 - PRIVACY RATING

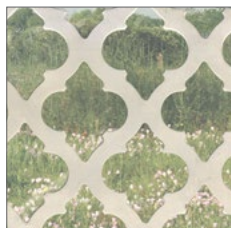

NOBLE
4 - PRIVACY RATING

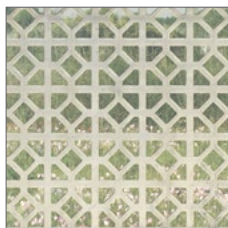

TRELLIS
6 - PRIVACY RATING

PLEASE NOTE:
Metal Grid options are not available with glass.

* All specifications, product designs and information listed are subject to change without prior notice.
We are continually improving our products, and these improvements may cause us to change the specifications listed.

Product Specifications: **BarnCraft® Knotty Alder Barn Doors**

Doors built for the BarnCraft® Barn Door Series are included in our BarnCraft® Rolling Doors & Hardware product catalog, and have the following specifications*:

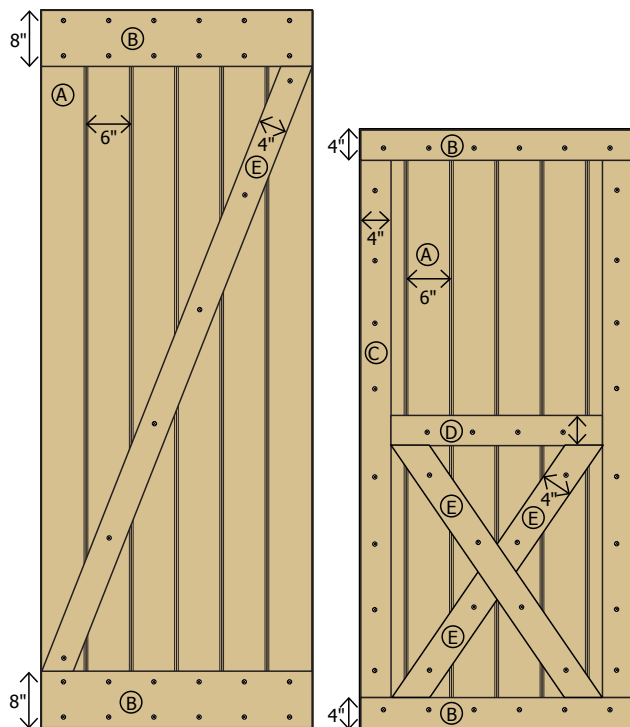

- 1) Most doors are available assembled and unassembled.
- 2) Unassembled doors are available unfinished only.
- 3) Unassembled doors are completely assembled, and then unassembled for shipment. An unassembled door is packed in a long box that is approved for UPS shipment.
- 4) 8 different barn door profiles are available (see opposite page). Not all profiles are available in all sizes, as smaller doors do not allow all cross rails and larger doors require cross rails for stability.
- 5) The "front" side only of all Barn Door profiles includes the cross rails.
- 6) The "back" side of all Barn Door profiles DO NOT include the cross rails, and include vertical planks only.
- 7) Door cross rails are constructed from 1" thick x 8" wide Knotty Alder on the Plank, Z, Mid Rail Plank, Double X, and Double Z door profiles.
- 8) Door cross rails are constructed using 1" thick x 4" wide Knotty Alder for the horizontal top, mid, and bottom cross rails and vertical stiles on the Two Panel, Double Z Two Panel, and X Two Panel door profiles.
- 9) All X and Z rails on all profiles use 1" x 4" Knotty Alder.
- 10) Door hangs 5/9" from the wall.

- **Available Stock Product Sizes:** Knotty Alder Barn Doors: See charts on the following pages.
- **Door Construction:** All barn doors use 3/4" thick planks with 1" thick rails. Doors are 1-3/4" thick.
- **Connection Method:** True tongue-and-groove planks. Rails are screwed onto planks.
- **Wood Specie Common Name:** Western Red Knotty Alder
- **Notes:** Design is offered on front side of door only.

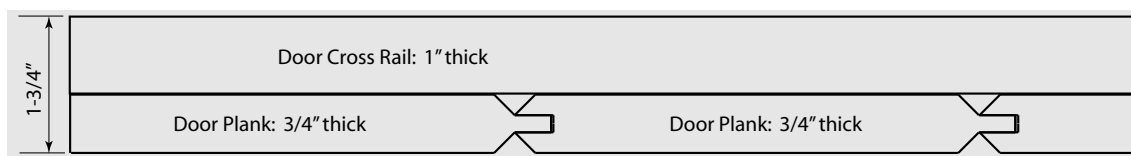

Barn Wood option

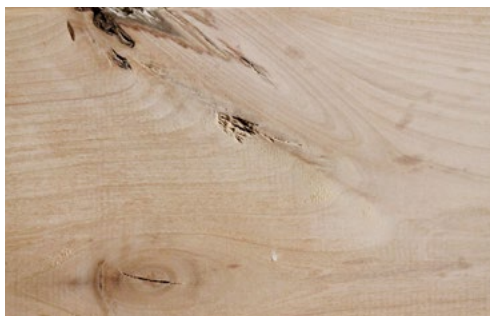

Rustic Wood option



Back side of all Barn Door Series doors

* All specifications, product designs and information listed are subject to change without prior notice.
We are continually improving our products, and these improvements may cause us to change the specifications listed.

Available Sizes for **BarnCraft® Knotty Alder Barn Doors**

Doors built for the BARN DOOR series of rolling doors are available sizes. Sizes in **YELLOW** are standard, and pricing for these doors is listed, along with product descriptions in our BarnCraft Door catalog and price list. Other doors listed on this chart are custom doors... please email to **orderentry@glasscraft.com** and request a price quotation. Be sure to include: height and width, specific door profile needed (see 8 available profiles shown below), and wood option required (Rustic or Barnwood).

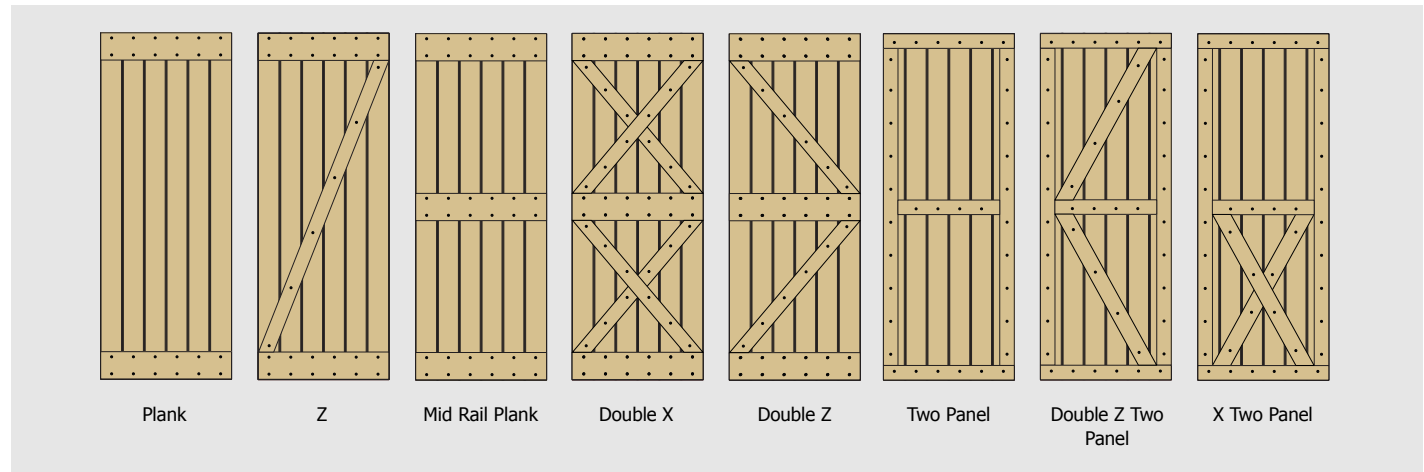

	Design Options	Width Options (Available in 6" increments)	Height Options (Available in 2" increments)
A	Plank design only	24" - 60" wide	48" - 96" height
B	Z, Mid Rail, 2 panel	24" - 84" wide	48" - 96" height
C	Double X, Double Z, Double Z 2 Panel, x 2 panel	24" - 84" wide	72" - 96" height

Product Specifications: BarnCraft® Iron Plank Doors

Knotty Alder doors built for the BarnCraft® Iron Plank Door Series are included in our BarnCraft® Rolling Doors & Hardware product catalog, and have the following specifications*:

- **Available Stock Product Sizes:** Knotty Alder Iron Plank Doors: See chart below.
- **Door Construction:** Doors use 3/4" thick planks with 1" thick metal edge.
- **Connection Method:** True tongue-and-groove planks. Planks slide into metal edge. Metal edge fits around planks.
- **Wood Specie Common Name:** Western Red Knotty Alder
- **Notes:**
 - a) Front and back side of door are the same.
 - b) Available unfinished or with factory finish.
 - c) Doors are 3/4" thick in the middle and 1" thick around edges.

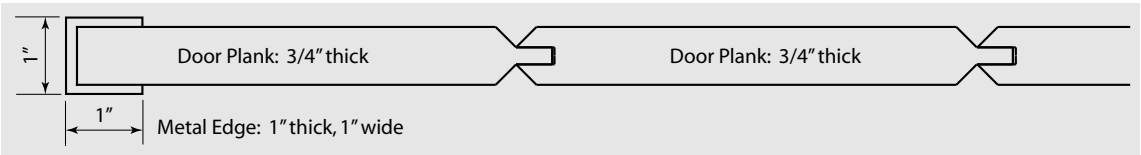
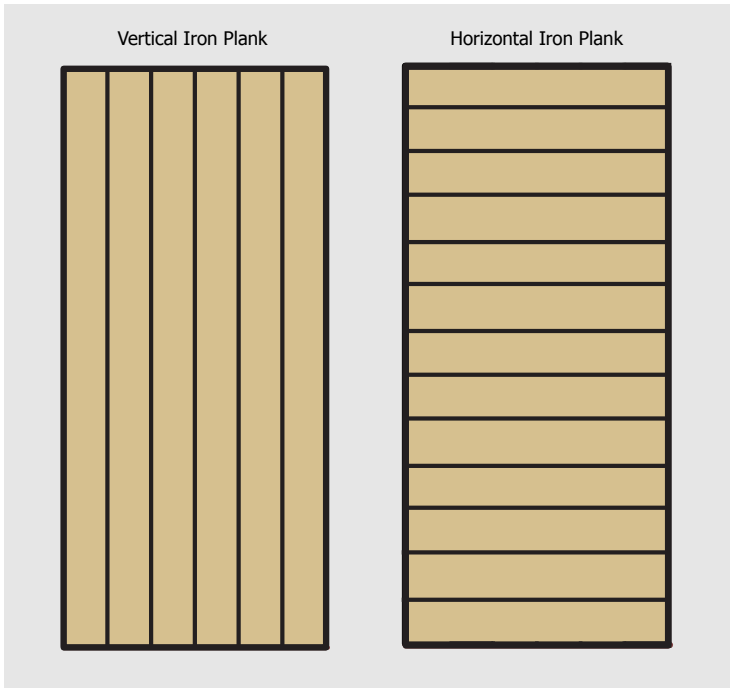

	Design Options	Width Options	Height Options
A	Vertical design	24" - 60" wide (Available in 6" increments)	48" - 96" height (Available in 2" increments)
B	Horizontal design	24" - 60" wide (Available in 6" increments)	48" - 96" height (Available in 6" increments)

* All specifications, product designs and information listed are subject to change without prior notice.
We are continually improving our products, and these improvements may cause us to change the specifications listed.

Product Specifications: BarnCraft® MDF Doors

Doors built for the BarnCraft® MDF Door Series are included in our BarnCraft® Rolling Doors & Hardware product catalog, and have the following specifications*:

- **Available Stock Product Sizes:** Knotty Alder Iron Plank Doors: See chart below.
- **Door Construction:** All MDF doors have a stile width of 5" and are constructed of 3 sheets of 1/2" MDF pressed together to make a 1-1/2" solid MDF door.
- **Door Material:** Heavy duty medium density fiber board (MDF)
- **Notes:**
 - a) Doors come white primed – no factory finish colors available.
 - b) Doors are heavy.
 - c) For the Blackboard MDF doors, use only real chalk. Chalk markers are NOT compatible with the chalkboard paint used on doors.

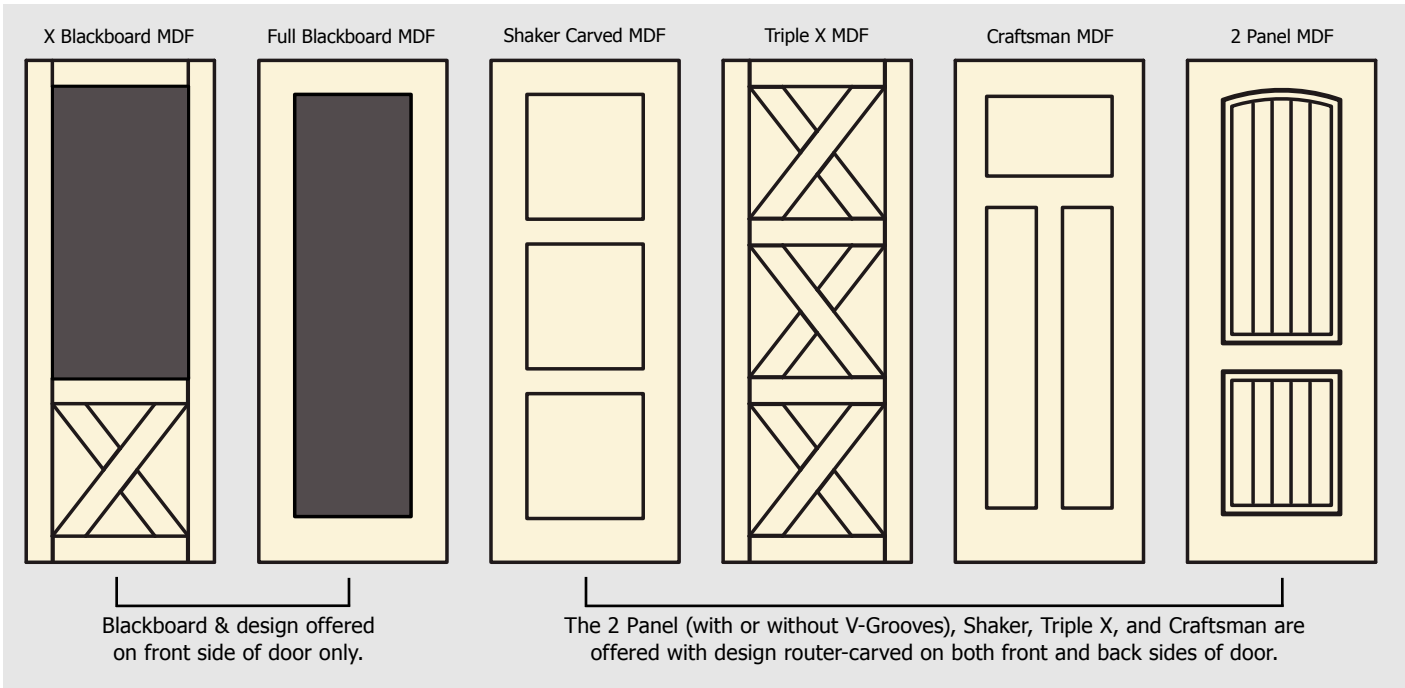

	Design Options	Width Options	Height Options
A	All MDF Designs	32", 36", 42", 48" wide	80", 84" ,96" height

* All specifications, product designs and information listed are subject to change without prior notice. We are continually improving our products, and these improvements may cause us to change the specifications listed.

Product Specifications: BarnCraft® Mahogany & Glass Doors

Mahogany doors built for the BarnCraft® Glass Door Series are included in our BarnCraft® Rolling Doors & Hardware product catalog, and have the following specifications*:

- 1) Solid wood construction in the stiles and rails. Stiles of these TDL series doors use a laminated-engineered construction method, which greatly reduces the possibility of warpage, without the potential problems of a veneer door.
- 2) TDL door panels are fully floating (not glued) for superior strength and longevity. Panels are 3 layers thick for strength and to greatly reduce the possibility of splitting.
- 3) All stile and rail joints use full cove and bead construction (instead of butt-gluing), and incorporate multiple grooved dowel construction at each joint. The top rail and lock rails use 3 dowels per side, and the large bottom rail uses 4 dowels per side.
- 4) Glass panels in these TDL Doors are "single glazed" or one piece of glass. All glass is tempered for safety.
- 5) Four glass texture options are available for these TDL Doors. See photos of texture options below.
- 6) The term "TDL" means True Divided Lite. This means that each glass panel is a separate and individual piece of glass, held in place by real or "true" wood mullions. Should one of these panes be broken, the individual piece is replaceable.

Available Stock Product Sizes:

TDL 6 Lite Single Doors	2' 8" x 6' 8" x 1 3/4"	2' 8" x 8' 0" x 1 3/4"
	3' 0" x 6' 8" x 1 3/4"	3' 0" x 8' 0" x 1 3/4"
(Continental 4 lite Doors only)	2' 6" x 6' 8" x 1 3/4"	2' 6" x 8' 0" x 1 3/4"

Stile Construction:

Doors 2–2.5mm (nominal) mahogany laminate over solid wood staves.
Laminate veneers are 2 layers thick.

Stile Width: All doors 6 1/4" wide

Stile & Rail Connection Method: Doweled Cove and Bead

Panel Thickness: 7/8" laminated panel.

Panel is three layers thick to eliminate splits through panel.

Wood Specie: Meranti Mahogany or equivalent

Design Options

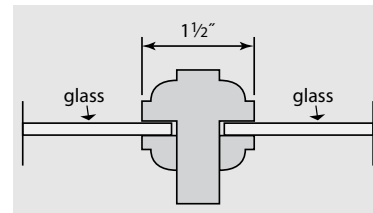
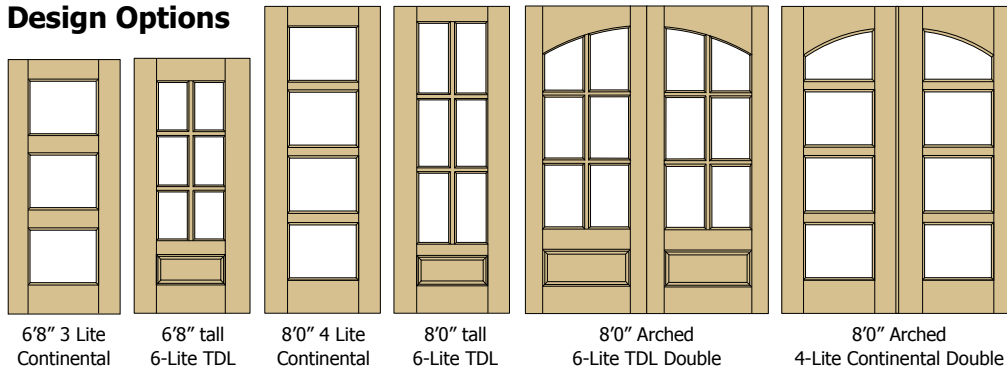

Glass Options

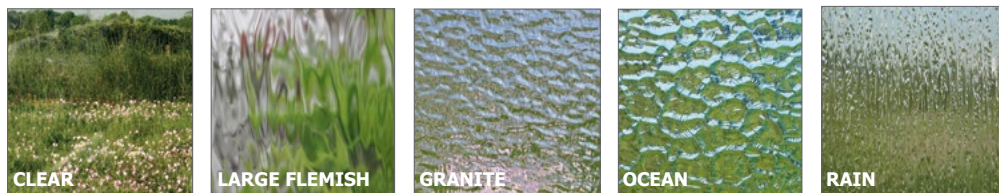

1 - PRIVACY RATING

5 - PRIVACY RATING

8 - PRIVACY RATING

8 - PRIVACY RATING

9 - PRIVACY RATING

Please Note: All glass is single glazed and tempered.

* All specifications, product designs and information listed are subject to change without prior notice.

We are continually improving our products, and these improvements may cause us to change the specifications listed.

Product Specifications: BarnCraft® Pull Handles & Hardware Options

Rolling Door Pull Handles

- 1) Pull handles for BarnCraft rolling doors are real hand-wrought iron. Slight appearance/size variance can be expected in each.
- 2) Pull Handles are packaged separately and uninstalled on all GlassCraft door products so the doors may be properly finished before the straps are installed. Metal door straps are individually bagged and boxed with screw fasteners included.
- 3) Handles may be ordered individually, without other products.
- 4) Metal door handles may be "touched up" with any exterior grade metal paint, such as Rustoleum™ if needed.

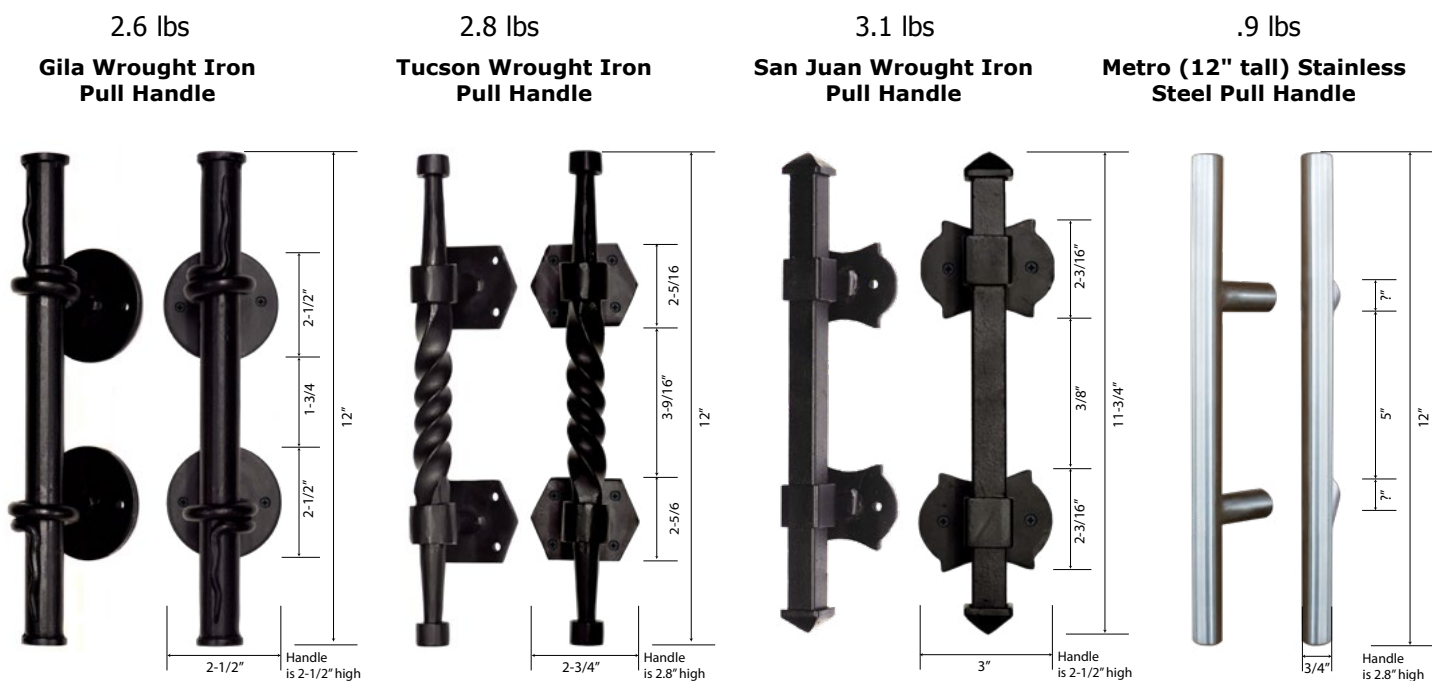
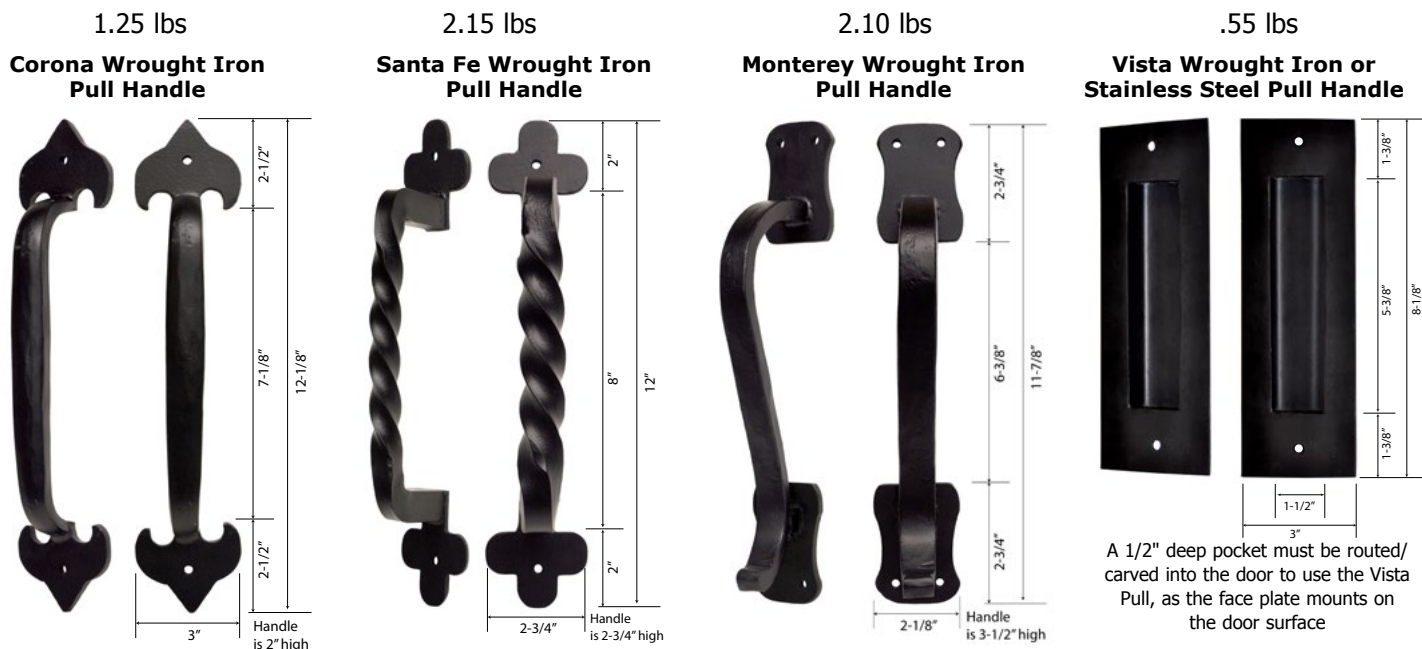

Product Specifications: **BarnCraft® Pull Handles & Hardware Options**

Metro (16" tall) Stainless Steel Pull Handle
1.2 lbs

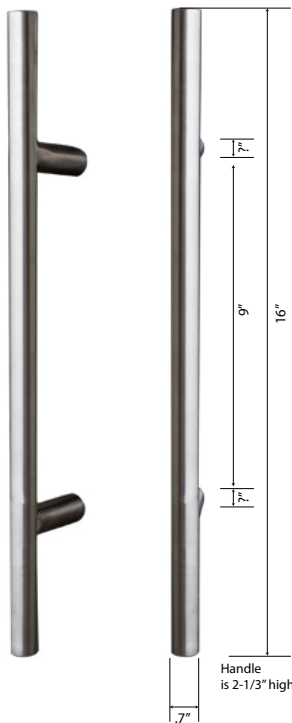

Soft-Close Attachment .60 lbs

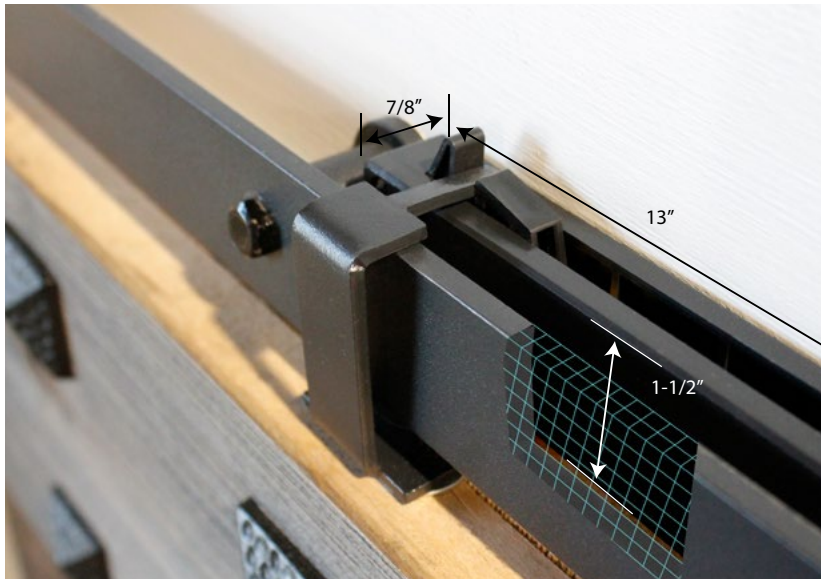

Optional Wall-Mounted Floor Guide

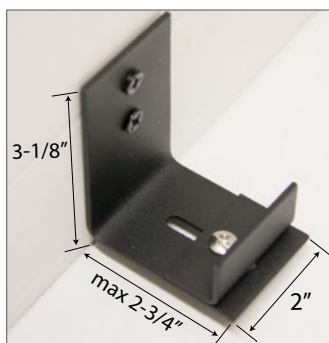

Bypass Bracket Kit = 8.80 lbs
Bypass Bracket = 1.75 lbs



Rail Connector = .30 lbs

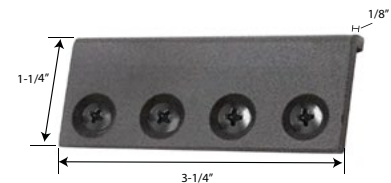

Rolling Door Lock Kits

These small lock kits are designed to be mounted on the edge of the opening over which the rolling door slides, and are available in black or stainless steel.

- 1) The lock mounting plate screws onto the opening with 3 screws; 2 round head screws on the top and bottom, and a flat head screw (not visible in the photos) in the middle.
- 2) The moving lock plate mounts using the 2 round head screws and 2 washers.
- 3) The rolling door lock plate mounts on the edge of back face surface of the rolling door. Note that a 1/8" x 1-1/2" slot that is 1/4" deep must be cut into the door. This rolling door lock plate mounts over the slot.
- 4) The lock is set by rotating the moving lock plate into the slot on the rolling door lock plate.

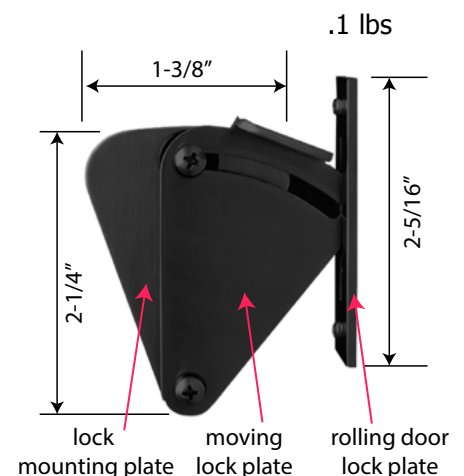

Product Specifications: **BarnCraft® Door Rollers**

- 1) Nominal dimensions for our 6 Rolling door rollers are shown here. These are hand-made products, and the dimensions may vary slightly.
- 2) All roller wheels are produced using a high durometer nylon and are considered "quiet-glide".
- 3) All roller fixtures are powder coated steel, have a nominal thickness of 1/4" and are black in color. Additionally, the Gage and Slade rollers are available in true stainless steel.

Installation Note:

For correct installation of all six Roller Designs, the distance from the bottom of the roller wheel to the top edge of the door must be 1-7/8".

Gage Door Rollers

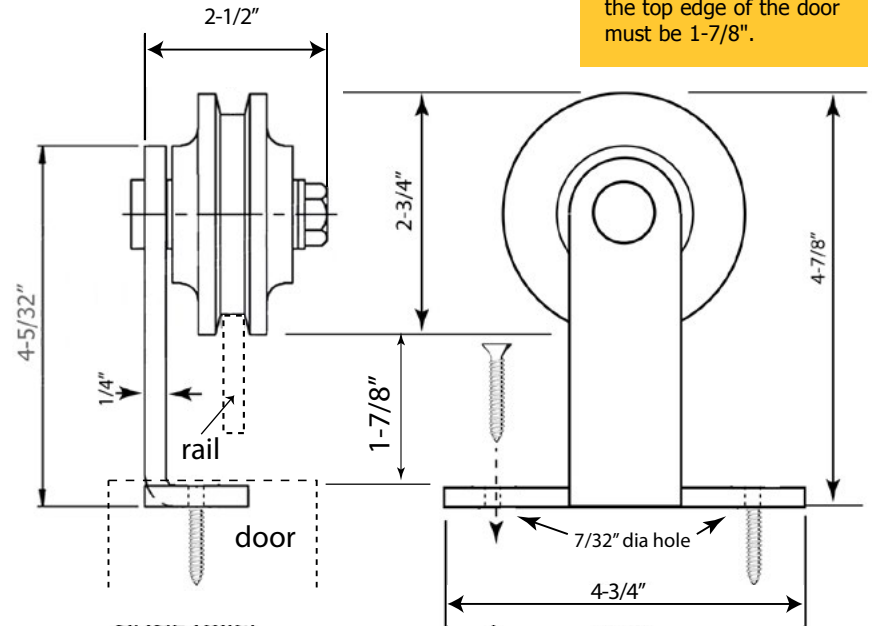

Philmont Door Rollers

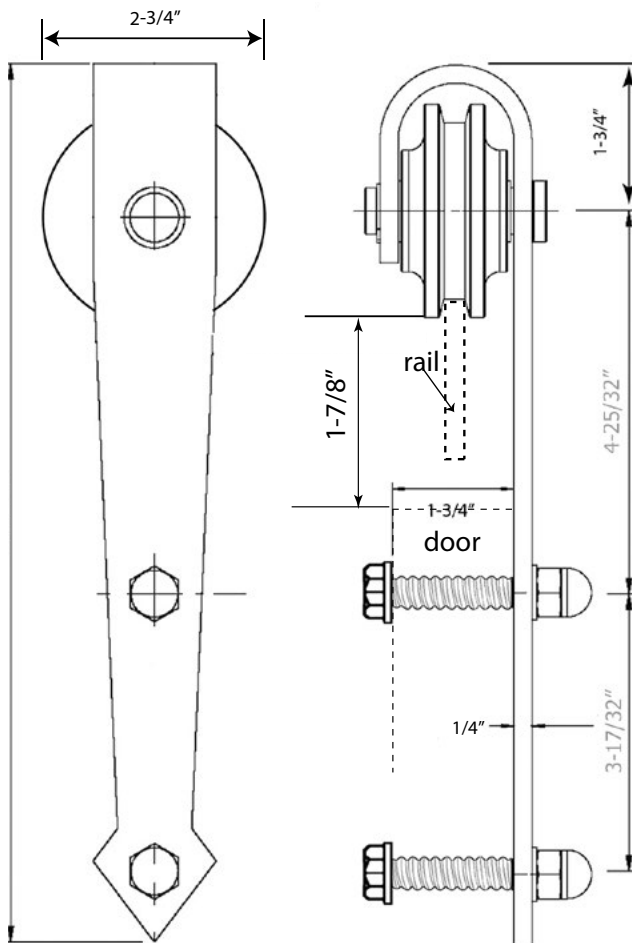

Slade Door Rollers

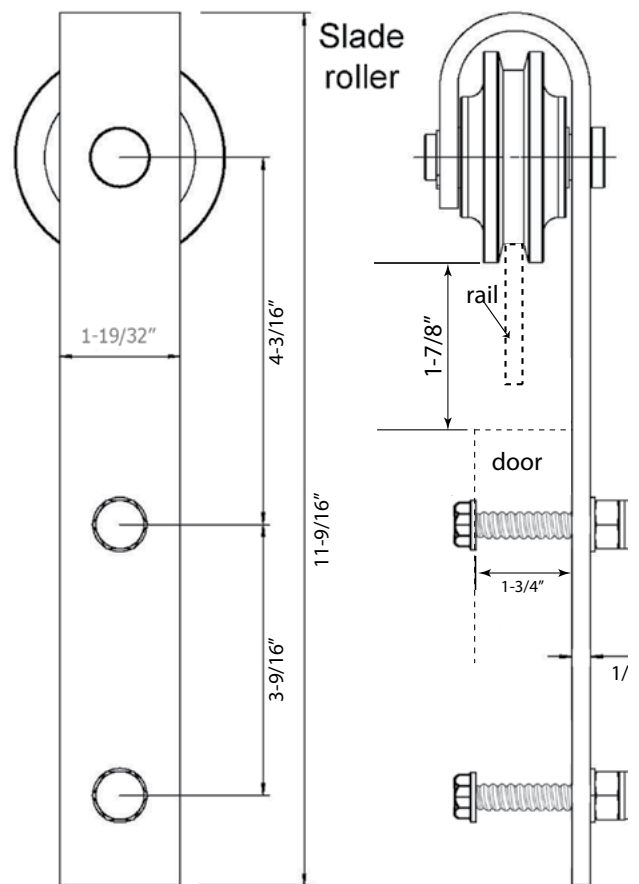

Product Specifications: **BarnCraft® Door Rollers**

Royal Door Rollers

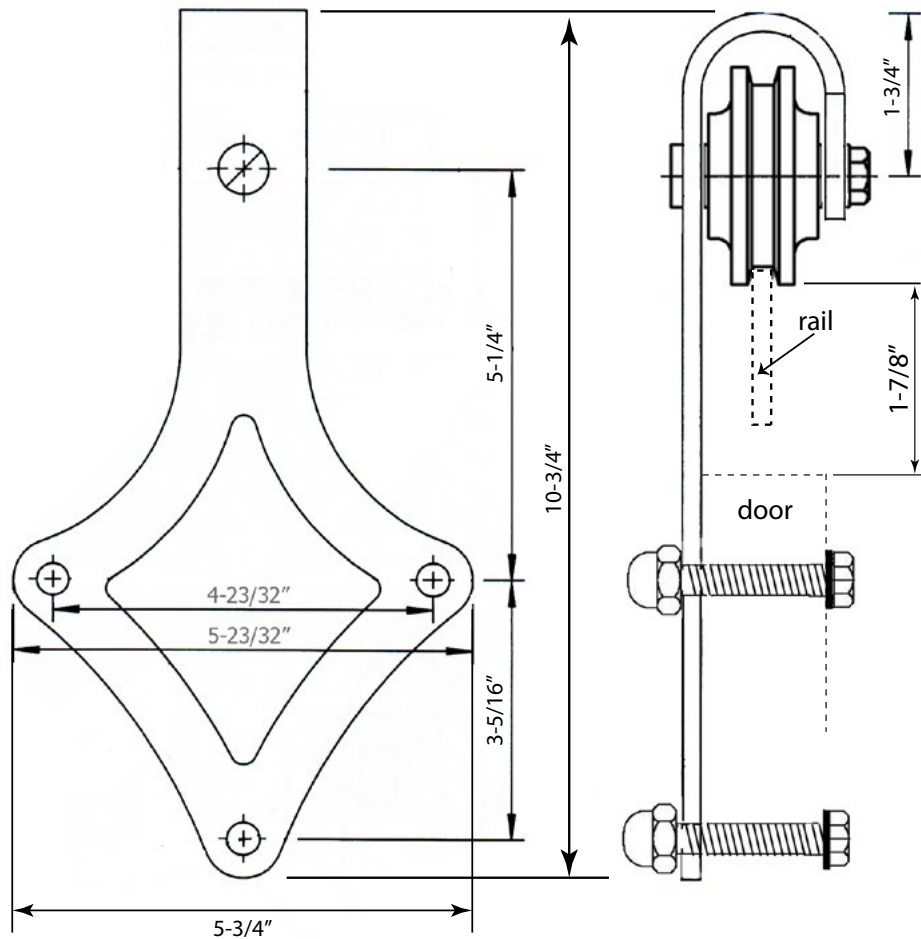

Waggoner Door Rollers

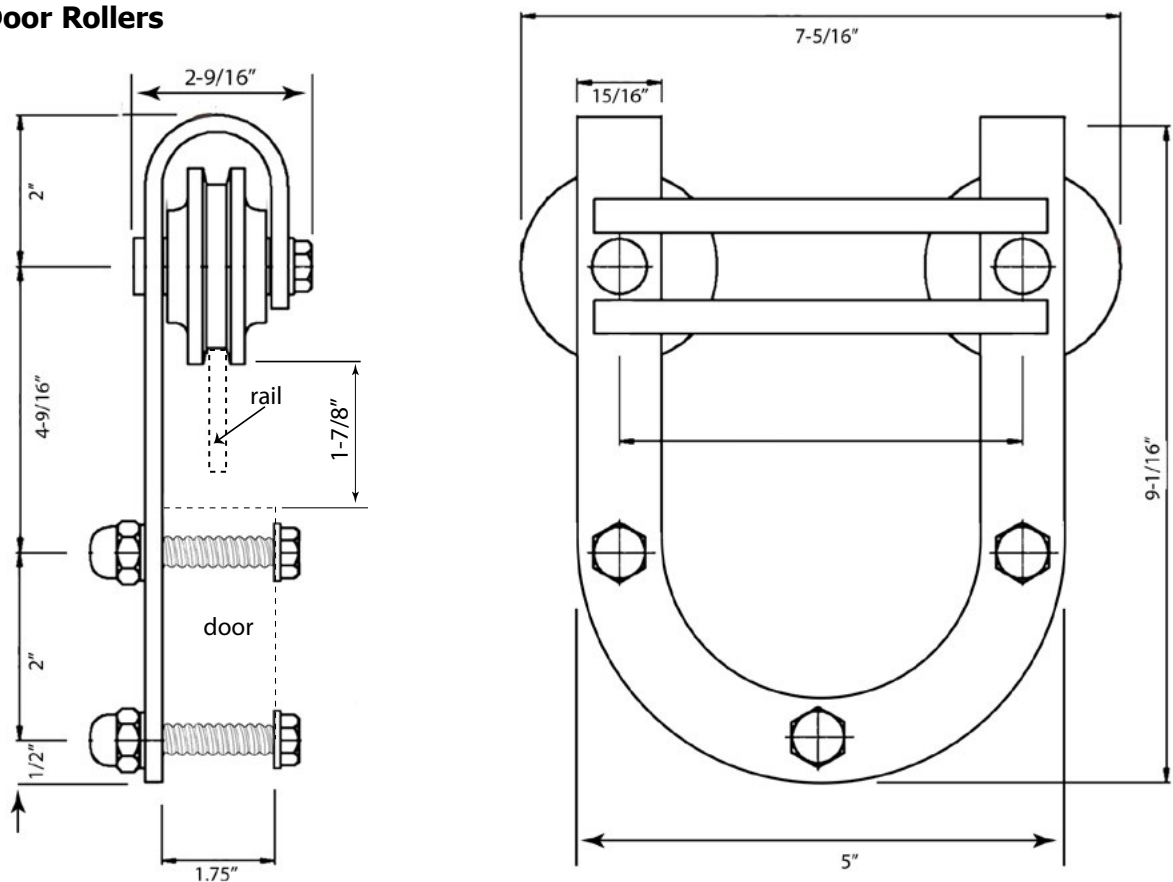

Product Specifications: **BarnCraft® Door Rollers**

Vintage Rollers

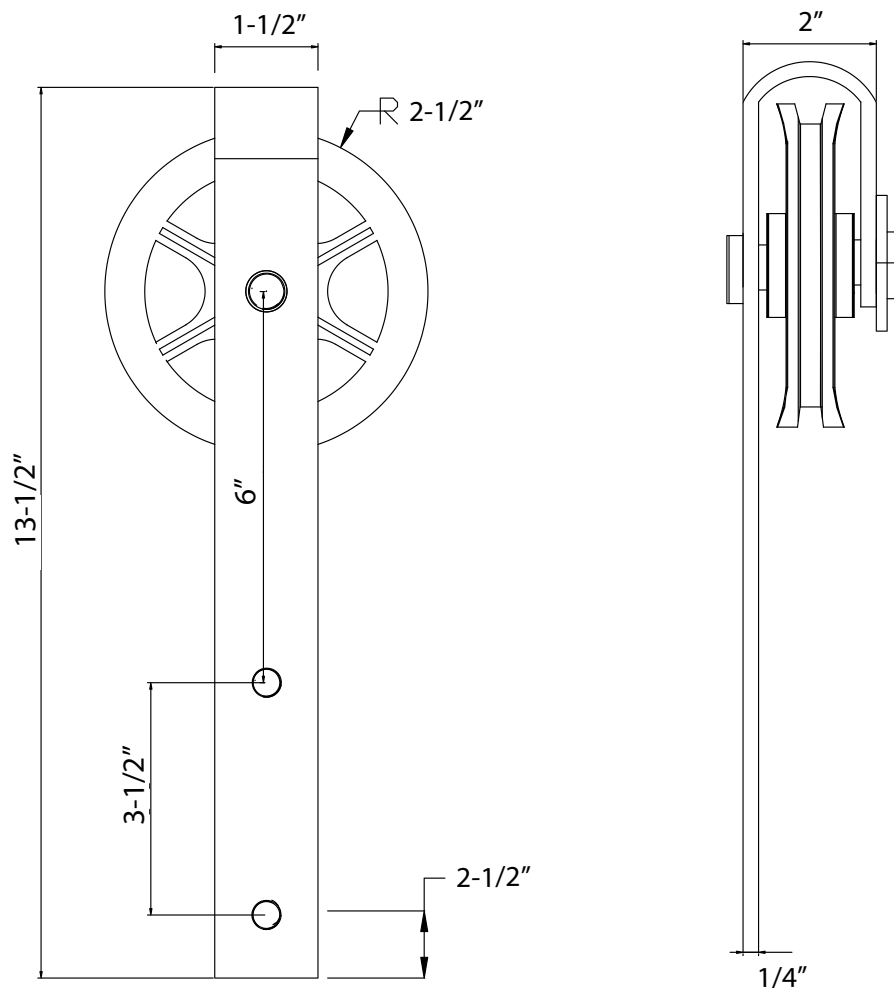

Product Information & Pricing: **BarnCraft® Hardware & Options**

Rolling door hardware & options for the BarnCraft® Door Series are included in our BarnCraft® Rolling Doors & Hardware Catalog, and Price List, and have the following specifications*:

- 1) We offer 8 Rolling Door hardware kits. 6 options in black and 2 designs in stainless steel.
- 2) Each kit includes all necessary hardware for one single rolling door installation. Not included is wood door header and header fasteners.
- 3) Each kit is packed in at least 2 boxes.
- 4) Metal door handles may be "touched up" with any exterior grade metal paint, such as Rustoleum™ if needed.
- 5) Kits include the rolling door rail.
- 6) All rolling door hardware is black in color, except for 2 stainless steel options. Hardware may be painted by the end user if desired.
- 8) **Installation Note: for correct installation, the distance from the bottom of the roller wheel to the top edge of the door must be 1-7/8".**

Product Specifications: BarnCraft® Rolling Hardware

BarnCraft Rolling Hardware



GAGE

79=17.95 lbs
90= 19.40 lbs
100=20.10 lbs



GAGE-Stainless Steel

79=17.95 lbs
90= 19.40 lbs
100=20.10 lbs



SLADE

79=17.95 lbs
90= 19.40 lbs
100=20.10 lbs



SLADE-Stainless Steel

79=17.95 lbs
90= 19.40 lbs
100=20.10 lbs



WAGGONER

79=17.95 lbs
90= 19.40 lbs
100=20.10 lbs



ROYAL

79=17.95 lbs
90= 19.40 lbs
100=20.10 lbs



PHILMONT

79=17.95 lbs
90= 19.40 lbs
100=20.10 lbs



VINTAGE

79=17.95 lbs
90= 19.40 lbs
100=20.10 lbs

Steel Rails are heavy-duty 1/4" (nominal) inch thick steel rails. Available in black or stainless steel, and in 2 lengths depending upon the door width: 78-3/4" and 100". See page 2 for more information on these rail lengths.



* All specifications, product designs and information listed are subject to change without prior notice. We are continually improving our products, and these improvements may cause us to change the specifications listed.

Product Specifications: BarnCraft® Options

Knotty Alder Header Option

We strongly suggest that the Rolling Door hardware be installed using a solid wood header board. This provides a potentially stronger and more secure installation. The photo at right shown an installation that uses a header board.

The header board is mounted to the wall, with fasteners (not supplied) screwed through the header board and into wall studs.

Then the rolling door hardware is mounted directly to the header board.

This makes installation potentially stronger and easier, as the holes in the steel rail will rarely align to existing wall studs.

You do not have to use GlassCraft header boards, you may choose to provide your own.

Header Length: 80", 108"



Additional Decorative Hardware

Our collection of iron door straps are not shown in our BarnCraft® Catalog. Four Clavos (decorative door nails) are shown on page 21. Door straps may be added as options to many of the doors shown in the catalog. Pricing for straps and strap sets are listed on the next page. Straps are built to the following specifications:

- 1) Straps for BarnCraft rolling doors are available in real hand-wrought iron.
- 2) Use decorative door straps or clavos for installation onto the face of a door to give it a rustic or antique look. Door straps or clavos can be mounted on the front (decorative) side of a rolling door only. Straps may be used with or without clavos.
- 3) These door straps and clavos are hand-made and therefore vary slightly. Metal straps include handmade mounting nails.
- 4) Each of the design series--*Madrid*, *Florentine*, *Williamsburg* and *Canterbury*, include long door straps and matching L and T shaped straps and angled corner straps. The "L strap" is for square door corners, the "T strap" is for the door stile and cross rail joint, and the "angled / arched L and T strap" is for doors with curved cross or top rails.
- 5) The iron door straps are "standard" with a powder coated black satin finish. These straps may be ordered with an antique bronze or an antique pewter finish as well, so that they match our standard wrought iron grill finish colors.
- 6) Straps and clavos are packaged separately and are not installed on all GlassCraft door products so the doors may be properly finished before the straps are installed. Metal door straps are individually bagged, with appropriate labeling, nails and mounting instructions.
- 7) Straps may be ordered individually, without other products. Straps are also available as "strap sets" for specific door profiles. Please refer to page 14 in our Mahogany & Knotty Alder Entry Doors color catalog for a description of these sets.
- 8) Metal door straps may be "touched up" with any exterior grade metal paint, such as Rustoleum™ if needed.
- 9) For the Barn Door Series of doors, the decorative clavos usually mount over or on top of the assembly screws.

Clavos:



Product Specifications: **BarnCraft® Options**

Straps:

Dummy Hinge Strap Series Options



28" Williamsburg Hinge Strap
HS3 Antique Black
HS3B Antique Bronze
HS3PB Antique Pewter



28" Canterbury Hinge Strap
HS4 Antique Black
HS4B Antique Bronze
HS4PB Antique Pewter



28" Madrid Hinge Strap
HS1 Antique Black
HS1B Antique Bronze
HS1PB Antique Pewter



28" Florentine Hinge Strap
HS2 Antique Black
HS2B Antique Bronze
HS2PB Antique Pewter



6" Arched L Strap
CS5 Antique Black
CS5B Antique Bronze
CS5PB Antique Pewter



6" L Strap
CS4 Antique Black
CS4B Antique Bronze
CS4PB Antique Pewter



12" T Strap
CS6 Antique Black
CS6B Antique Bronze
CS6PB Antique Pewter



6" Arched L Strap
CS2 Antique Black
CS2B Antique Bronze
CS2PB Antique Pewter



6" L Strap
CS1 Antique Black
CS1B Antique Bronze
CS1PB Antique Pewter



12" T Strap
CS3 Antique Black
CS3B Antique Bronze
CS3PB Antique Pewter

1 Year Door Warranty, 5 Year Warranty on Hardware

Our Warranty to you...

GlassCraft BarnCraft Rolling Door products are designed to create lasting value and beauty for your home, and this warranty is effective for all prefinished wood doors, unfinished assembled or unassembled wood doors, and rolling door hardware (the "product") sold by GlassCraft on or after September 1, 2015 for use in the United States. For additional information, or to report a warranty claim, see your dealer or refer to www.glasscraft.com.



We warrant that, subject to the conditions and exclusions stated below, each prefinished or unfinished BarnCraft wood door or wrought iron grille will be free from defects in material and workmanship which would render the product unfit for normal and recommended use and service when installed in the continental USA. GlassCraft Door Company ("GlassCraft") warrants this product only to the first purchaser of the product for purposes other than resale, or to the original purchaser of the residence into which such door is installed. This warranty covers defects which become evident during the period outlined below, provided that the owner gives written or electronic notice of the defects to GlassCraft Door Company, 2002 Brittmoore, Houston, Texas 77043, within the applicable time period. This warranty constitutes the sole and exclusive warranty offered by GlassCraft Door Company: it is not transferable; and no dealer, distributor, or representative of GlassCraft has the authority to modify or expand this warranty.

Wood Doors

GlassCraft Door Company offers a limited warranty for one (1) year for all factory-finished wood doors, unfinished wood doors, or unassembled wood doors from the date of first purchase from GlassCraft of the product; this warranty assuring that each product, for this period, is of good material and workmanship and free from defects that would render the product unserviceable or unfit for the ordinary, recommended use. The following shall not be considered defects in material or workmanship, and are not covered by this warranty:

1. Warp of up to 1/4" in any plane of the door for any 6'8" tall door up to 36" wide. Warp of up to 1/2" in any plane of the door for doors taller than 6'8" and up to 8 foot tall and up to 42" wide. Doors wider and/or taller are not warranted against warp. Surface checks in the doors that are less than 1/8" in width or less than 2" in length are not warranted.
2. Normal wear of the door, natural variation in wood color or texture, and the physical appearance of the door, including the appearance of the finish or fading of the stain color are not covered. Appearance or performance of a wood knot is not covered by this warranty.
3. Glass breakage or glass damage for any reason. The physical appearance of a glass panel is not covered by this warranty.
4. Rusting or metal deterioration or appearance of an iron grille or door assembly fasteners or decorative straps or clavos.
5. Damage caused beyond the control of GlassCraft, including but not limited to damage caused by misuse, abuse, accident, or mishandling, or by fire, flood, earthquake, hurricane, storm, tornado, or other acts of nature.
6. Damage resulting from reducing the height of the door by removing more than 1" from the bottom rail and/or 1/2" from the top rail of the door or reducing the width of the door by removing more than 1/2" from either side edge.
7. Panel movement or shrinkage. Damage caused by field finishing or painting of the door.
8. Damage caused by improper installation of the door or door hardware.

Rolling Door Hardware

GlassCraft Door Company offers a limited warranty for five (5) years for our BarnCraft Rolling Door hardware from the date of first purchase from GlassCraft of the product; this warranty assuring that product, for this period, is of good material and workmanship and free from defects that would render the product unserviceable or unfit for the ordinary, recommended use. The following shall not be considered defects in material or workmanship, and are not covered by this warranty:

1. Normal wear of the part.
2. Damage caused by improper installation of the door or door hardware.
3. Rusting or metal deterioration or appearance of the hardware.
4. Periodic maintenance or adjustments.
5. Hardware that is modified by the user or installer.

6. Hardware failure due to overloading.
7. Hardware failure due to improper use in an application outside of the products normal, intended use.
8. Damage caused beyond the control of GlassCraft, including but not limited to damage caused by misuse, abuse, accident, or mishandling, or by fire, flood, earthquake, hurricane, storm, tornado, or other acts of nature.

Claims Procedure and Limit on Remedies

All warranty claims must be presented as outlined above, within the warranty period. We will not honor warranty claims made prior to payment in full for the warranted product. Upon validation by GlassCraft of any warranty claim, we will (at our option):

- 1) Provide a replacement or replacement part(s) at no cost to the customer, and return it to the customer, FOB GlassCraft in Houston, Texas.
- 2) Refund the purchase price paid for the product by the original purchaser of the product from GlassCraft Door Company.
- 3) Provide a replacement at a cost of 25% of the current list price of the product, and return it to the customer, FOB GlassCraft in Houston, Texas.

We reserve the right to inspect any product that is alleged to be defective. GlassCraft may require that the purchaser return the product to GlassCraft in Houston for inspection. Or we may choose to send a company or field representative to inspect the product in the field, in which case we must be given at least a thirty-day opportunity to do so. All freight costs to and from GlassCraft for a warranty claim are the responsibility of the purchaser.

THIS CONSTITUTES THE PURCHASER'S SOLE AND EXCLUSIVE REMEDY UNDER ANY CLAIM OR THEORY OF LIABILITY. THERE ARE NO WARRANTIES THAT EXTEND BEYOND THE DESCRIPTION ON THE FACE HEREOF. ALL IMPLIED WARRANTIES, INCLUDING MERCHANTABILITY, ARE EXCLUDED. GLASSCRAFT SHALL NOT BE LIABLE FOR CONSEQUENTIAL, INDIRECT, OR INCIDENTAL DAMAGES OF ANY NATURE INCLUDING, WITHOUT LIMITATION, LABOR COST OF ANY KIND ARISING FROM OR IN CONNECTION WITH AN ALLEGED BREACH OF ANY WARRANTY OR NEGLIGENCE ON THE PART OF GLASSCRAFT DOOR COMPANY. IN NO EVENT SHALL GLASSCRAFT PAY FOR THE COST OF LABOR, INSTALLATION, REMOVAL, DISPOSAL, OR FINISHING OF A REPLACEMENT OR ORIGINAL DOOR OR GLASS PANEL OR FOR ANY OTHER COST RELATING THE REPLACEMENT OF A DOOR OR GLASS PANEL, ALL OF WHICH SHALL BE THE SOLE RESPONSIBILITY OF THE PERSON MAKING THE WARRANTY CLAIM.

This warranty is effective for products sold after September 1, 2015.